

ISO 9001:2015 & CE Certified Company

Stainless Steel Submersible Pumps

50Hz Catalogue



PUMPS | PIPES | CABLES | SOLAR PUMPS

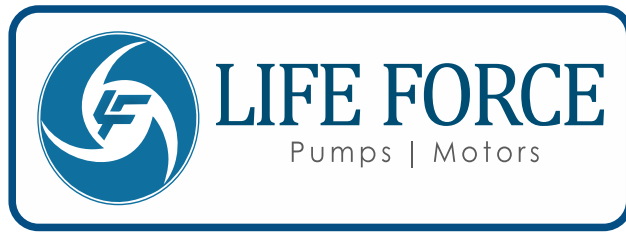

ISO 9001:2015 & CE Certified Company

Stainless Steel Submersible Pumps



The Company

We build superior quality and energy efficient pumps and our aim is to provide pumping solutions to our end customers by giving them a proper guidance and solution. We are also committed to green environment movement by offering and continuously improving energy efficiency.

we also work as a Metal Die (tool) making and customs pump design. and provide all types of job work in sheet metal.

We know the value of water had become real and concrete, since then water installations are considered a primary good. Life Force Pumps is committed to study, to develop, to manufacture and to industrialize pumping systems.

In Life Force Pumps, we are continuously looking for the development of the products that fulfill the need of our customers. Main motive of our company is to satisfy the need of our customer by providing water solutions.

We are here to build relationship with minimum optimum expense from our users.

We have a 25 year Experience team in research and development on this industries.

Our Highly Experience research and development team are always move to provide water solution for the irrigation need.

Mission

- We aspire to provides high quality products that combine performance with value pricing, while establishing a successful relationship with our customers and our suppliers to gaining their trust.
- To constantly strive to meet our customer needs and expectations with comparative price, service, and selection to provide/enhance customer satisfaction. At the end, we will perform timely reviews of the marketplace to improve our products.
- To stay ahead by developing new products and services based on the customer needs and market demand.



Content

Page No.

Submersible Pumps – Life Force Pumps Series

Performance Range	03
Pumps Range	04
Motors Range	04
Application	05
Type Key	05
Pumped Liquids	05
Operating Conditions	05
Curve Conditions	05
Features and Benefits	06
Material Specification	07
Submersible Motors OSF 150 Outline Drawing	08
Application of Submersible Motor OSF 150	09
Technical Specification and Material of Motors	09
Performance Data of Submersible Motors	10

Technical Data and Performance Curve

Pumps LFP 2-V4	11 – 13
Pumps LFP 3-V4	14 – 16
Pumps LFP 5-V4	17 – 19
Pumps LFP 8-V4	20– 22
Pumps LFP 14-V4	23 –25
Pumps LFP 10-V6	26 – 27
Pumps LFP 12-V6	28 – 29
Pumps LFP 17-V6	30 – 31
Pumps LFP 30-V6	32 – 33
Pumps LFP 46-V6	34 – 35
Pumps LFP 60-V6	36 – 37
Pumps LFP 77-V8	38 – 39
Pumps LFP 95-V8	40 – 41
Pumps LFP 125-V10	42 – 43
Pumps LFP 160-V10	44 – 45
Table of Head Losses in Ordinary Water Pipes	46
Table of Head Losses in Plastic Pipes	47

PERFORMANCE RANGE OF LFP SERIES

www.lifeorcepumps.com

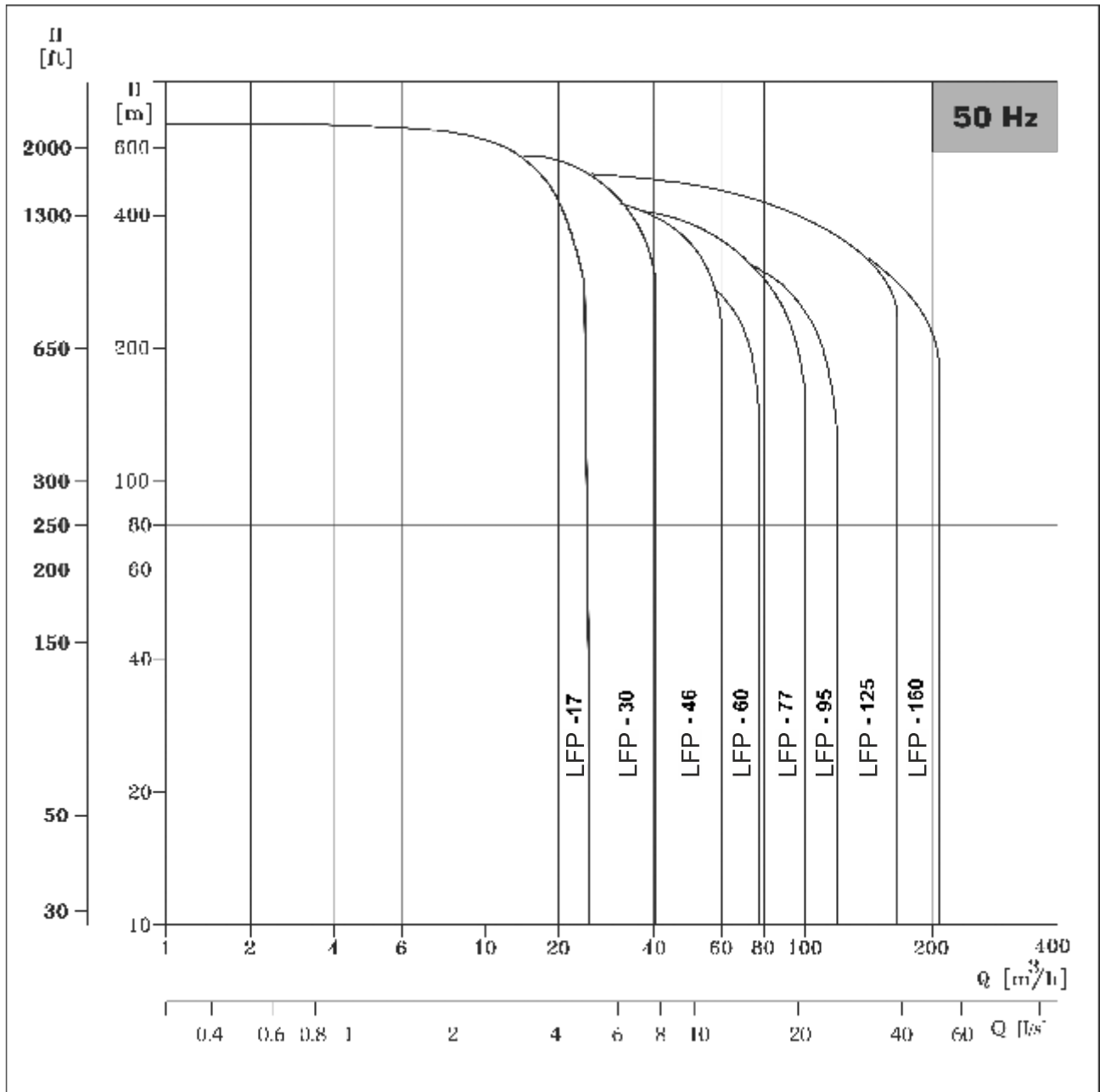

Pump Range

Type	LFP 10	LFP 12	LFP 17	LFP 30	LFP 46	LFP 60	LFP 77	LFP 95	LFP 125	LFP 160
Steel: AISI SS 304	+	+	+	+	+	+	+	+	+	+
Connetion : Rp (Inches) BSP Thread	2.0"	2.0"	2.5"	3"	4"	4"	5"	5"	6"	6"
NPT Thread	3.0"	3.0"	3"	3"	4"	4"	5"	5"	6"	6"
Flange Connection							5"	5"	6"	6"

Motor Range

Motor Output (kW)	3.0	4.0	5.5	7.5	9.2	11	13	15	18.5	22	26	30	37	45	55	75	93	110
Three Phase	+	+	+	+	+	+	+	+	+	+	+	+	+	+	+	+	+	+
Rewindable Motors	+	+	+	+	+	+	+	+	+	+	+	+	+	+	+	+	+	+
Steel: AISI 304 & Cast Iron	+	+	+	+	+	+	+	+	+	+	+	+	+	+	+	+	+	+

Direct - on - Line starting is recommended up to 7.5 kW.

Soft starter or autotransformer is recommended above 7.5 kW.

Applications

The pumps are suitable for the following applications:

- raw water supply
- irrigation systems
- groundwater lowering
- pressure boosting
- industrial applications

Type Key

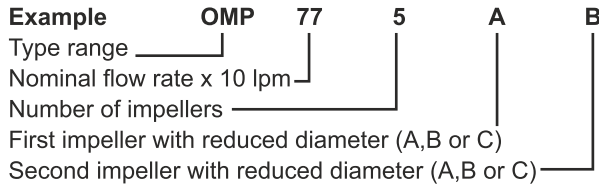

Pumped Liquids

Clean, thin, non-aggressive liquids without solid particles or fibres. The max. sand content is 50 mg/lit.

Operating Conditions

Flow rate Q Maximum : 8 - 204 m³/h
 Head H : max. 670m

Maximum Liquid Temperature

Motor	Installation		
	Flow Velocity Past Motor	Vertical	Horizontal
6" & 8"	0.15 m/s	40°C	40°C

Curve Conditions

Curve tolerance according to ISO 9906, Annex A

- The performance curves show pump performance at actual speed cf. standard motor range.
- The speed of the motors is approximately :

4" and 6" motors : n=2870 min-1
 8" to 12" motors : n=2900 min-1

- The measurements were made with airless water at a temperature of 20°C. The curves apply to a kinematic viscosity of 1mm²/s. When pumping liquids with density higher than that of water, motors with correspondingly higher outputs must be used.

- The bold curves indicate the recommended performance range.

- The performance curves are inclusive of possible losses such as non-return valve loss.

Table of Head Losses

LFP 10, LFP 12, LFP 17, LFP 30, LFP 46, LFP 60, LFP 77, LFP 95, LFP 125, LFP 160 Curves

- Q/H : The curves are inclusive of valve and inlet losses at the actual speed.

- Operation without non-return valve (NRV) will increase the actual head at nominal performance by 0.5 - 1.0 m.

- NPSHR The curve is inclusive of suction case and shows required inlet pressure.

- Power Curve: It shows pump power input at the actual speed for each individual pump size.

- Efficiency Curve : Efficiency shows pump stage Efficiency.



SUBMERSIBLE PUMPS

1 Bearings with sand channels

All bearings are water-lubricated and have a squared shape enabling sand particles, if any, to leave the pump together with the pumped liquid.



2 Inlet strainer

The inlet strainer prevents particles over a certain size from entering the pump.



3 Priming screw

All Life Force 4" pumps are fitted with a priming screw. Consequently, dry running is prevented, because the priming screw will make sure that pump bearings are always lubricated.

Due to the semi-axial impellers of large pumps this priming is provided automatically.

However, it applies to all pump types that if the water table is lowered to a level below the pump inlet neither pump nor motor will be protected against dry running.

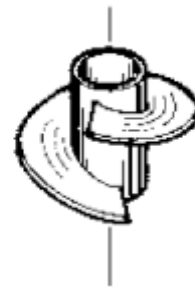

4 Non-return valve

All pumps are equipped with a reliable non-return valve in the valve casing preventing back flow in connection with pump stoppage.

Furthermore, the short closing time of the non-return valve means that the risk of destructive water hammer is reduced to a minimum.

The valve casing is designed for optimum hydraulic properties to minimize the pressure loss across the valve and thus to contribute to the high efficiency of the pump.

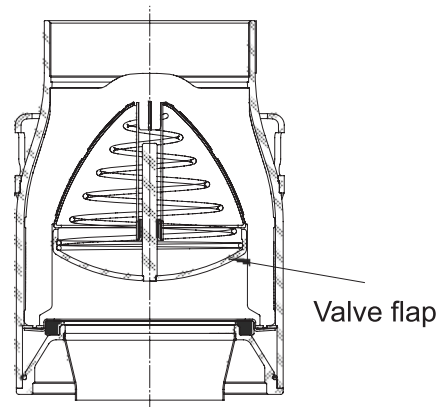

5 Stop ring

The stop ring prevents damage to the pump during transport and in case of up-thrust in connection with start-up.

The stop ring, which is designed as a thrust bearing, limits axial movements of the pump shaft.

The stationary part of the stop ring (A) is secured in the upper chamber.

The rotating part (B) is fitted above the split cone (C).

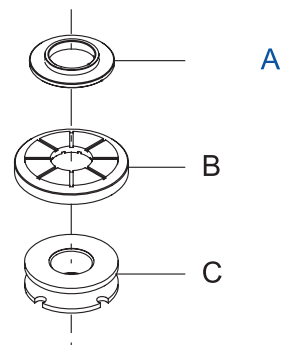

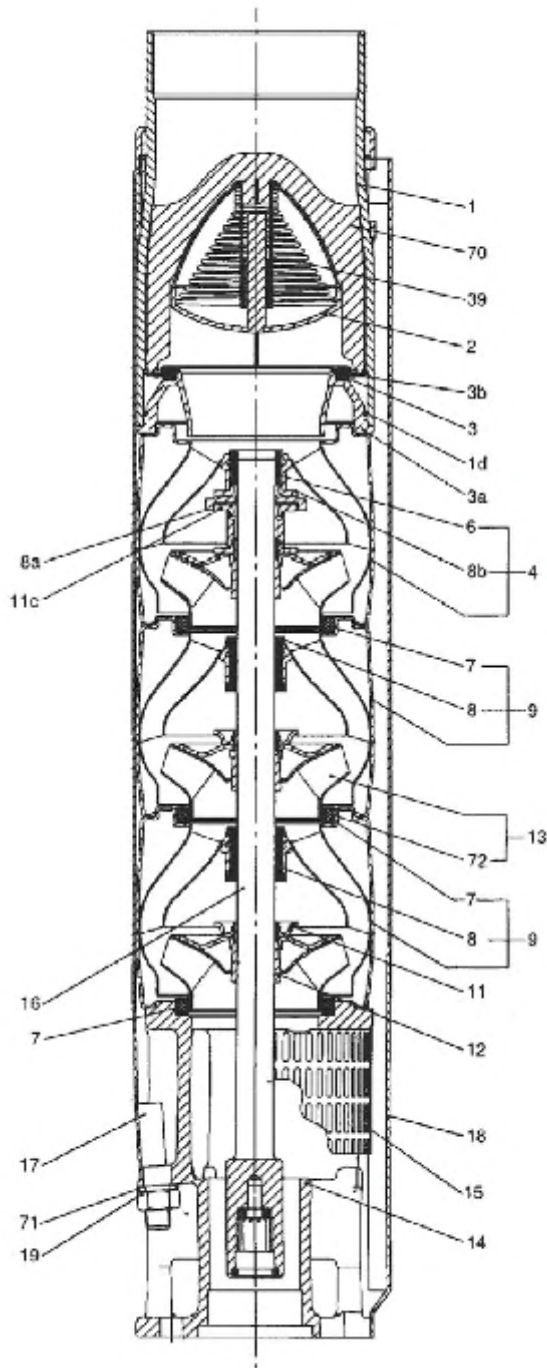

SUBMERSIBLE PUMP MODEL LFP77

POS	COMPONENTS	MATERIAL	STANDARD	VERSION
1	VALVE CASING	STAINLESS STEEL	304	318
1d	O-RING	NBR		
2	VALVE CUP	STAINLESS STEEL	304	318
3	VALVE SEAT	STAINLESS STEEL	304	318
3a	LOWER VALVE SEAT RETAINER	STAINLESS STEEL	304	316
3b				
3c	UPPER VALVE SEAT RETAINER	STAINLESS STEEL	304	318
4	TOP CHAMBER	STAINLESS STEEL	304	318
5	UPPER BEARING	STAINLESS STEEL NBR	304	316
6	NECKING	NBR11'S		
6	BEARING	NBR		
6a	WASHER FOR STOP RING	CARBON/GRAPHITE -NY22 IN PTFE MASS		
6b	STOP RING	STAINLESS STEEL	316	318
7	CHAMBER	STAINLESS STEEL	304	316
7	SPLIT CONE NUT	STAINLESS STEEL	304	318
7c	NUT FOR STOP RING	STAINLESS STEEL	316	318
7	SPLIT CONE	STAINLESS STEEL	304	316
7	IMPELLER	STAINLESS STEEL	304	318
7	SUCTION INTERCONNECTOR	STAINLESS STEEL	304	318
7	STRAINER	STAINLESS STEEL	304	318
7	SHAFT COMPLETE	STAINLESS STEEL	431	318
7	STRAP	STAINLESS STEEL	304	316
7	CABLE GUARD	STAINLESS STEEL	304	318
7	NUT FOR STRAP	STAINLESS STEEL	304	316
7	STRAP FOR VALVE CUP	STAINLESS STEEL	304	316
7	VALVE GUIDE	STAINLESS STEEL	304	316
7	WASHER	STAINLESS STEEL	316	318
7	WEAR RING	STAINLESS STEEL	304	318

6" Rewindable HSF 150 : 4 – 37 kW / 5.5 - 50 HP

Thrust Rating : 15500 - 27500

HSF 6" Outline

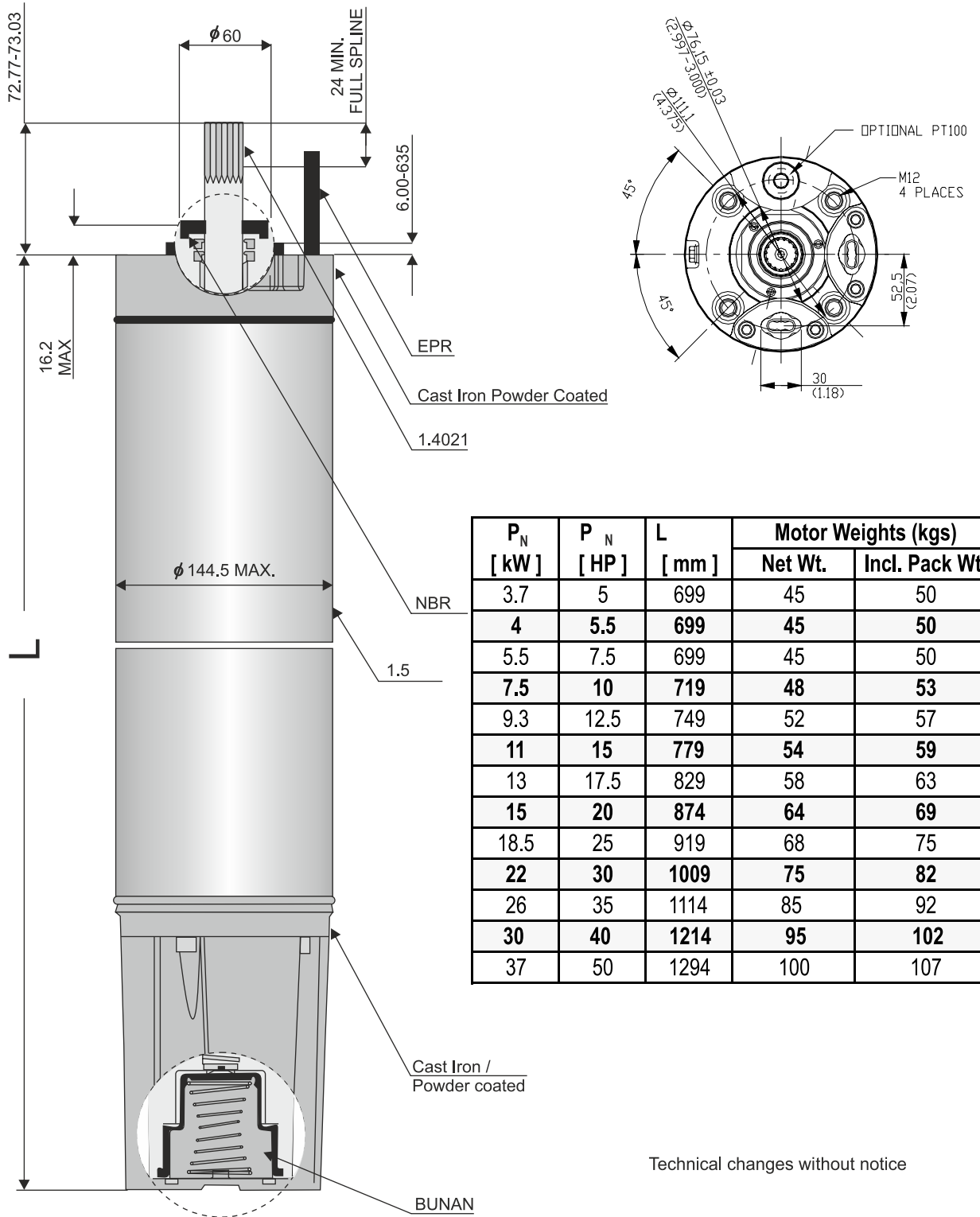

P _N [kW]	P _N [HP]	L [mm]	Motor Weights (kgs)	
			Net Wt.	Incl. Pack Wt.
3.7	5	699	45	50
4	5.5	699	45	50
5.5	7.5	699	45	50
7.5	10	719	48	53
9.3	12.5	749	52	57
11	15	779	54	59
13	17.5	829	58	63
15	20	874	64	69
18.5	25	919	68	75
22	30	1009	75	82
26	35	1114	85	92
30	40	1214	95	102
37	50	1294	100	107

Technical changes without notice



6" Rewindable LFP 150 : 4-37 kW / 5.5 -50 HP

Thrust Rating : 15500 - 27500

6" Rewindable Motors Product Information

Application

6" Rewindable motors are built for dependable operation in 6" diameter or larger water wells. Water lubricated thrust and radial bearings enable a maintenance free operation. The motors are ready to operate, providing frost protection down to - 15°C. Fill and check valve, as well as a preloaded special diaphragm, ensure pressure compensation inside the motor. (Inside pressure 0,5 - 0,7 bar)

Other Product advantages :

- Cable material according to drinking water regulations.
- Sand slinger and shaft seal for high performance in sand.
- High efficiency electrical design for low operation cost.
- All motors prefilled and 100% tested
- Design for retrofitable PT100 sensor

Technical Specification

Standard Motors

- 6" NEMA - flange with studs (M 12)
- Protection : IP 68
- Starts per hour: max. 20
- Installation position: vertical / horizontal
- Motors Lead in 4m length
- Voltage tolerance: +6% / -10%
- (Standard: 415 + 6%=440V. 380-10% = 342V)
- Motors protection: Select Taping winding insulation for max. ambient of 30 with a min.

Optional

- PT 100 temperature sensor (sold separately)
- Drop cable in different length up to 50m

Material

Part	Material AISI
	304 (Standard)
Shell	(SS AISI 304)
Endbell Diaphragm cover	Cast Iron / powder coated
Housing thrust bearing	Cast Iron Powder Coted
Seals	BUNA N
Seal Cover	(SS AISI 304)
Shaft Cover	SiC
Shaft end 4kW-22kW / 5.5 HP - 30 HP	(SS AISI 410)
Shaft end 26kW-37kW / 35 HP - 50 HP	(SS AISI 410)
Diaphragm	EPR

Technical Changes without notice



6" Rewindable LFP 150 : 4-37 kW / 5.5 -50 HP

Thrust Rating : 15500 - 27500

LFP 150 - Rewindable Motors Performance Data 50 Hz

P _N HP / kW	Thrust F [N]	U _N [V]	n _N [min ⁻¹]	I _N [A]	I _A [A]	η (Eff.) [%] at % load			cos φ (PF) at % load			T _N [Nm]	T _A [Nm]
						50	75	100	50	75	100		
5.5 / 4.0	15500	380	2910	10,4	48	0,71	0,75	0,76	0,59	0,71	0,78	13,1	15,5
		400	2930	10,6	51	0,68	0,73	0,76	0,53	0,65	0,73	13,1	17,3
		415	2930	10,9	53	0,65	0,72	0,76	0,50	0,61	0,69	13,0	18,8
7.5 / 5,5	15500	380	2860	13,7	48	0,74	0,76	0,75	0,67	0,78	0,83	18,3	15,5
		400	2890	13,3	51	0,72	0,76	0,76	0,62	0,74	0,81	18,2	17,3
		415	2890	13,4	53	0,71	0,75	0,75	0,59	0,71	0,78	18,1	18,8
10.0 / 7,5	15500	380	2860	18,3	59	0,77	0,78	0,76	0,70	0,80	0,84	25,0	19,2
		400	2880	17,7	63	0,75	0,78	0,77	0,65	0,76	0,82	24,8	21,5
		415	2890	17,7	65	0,73	0,77	0,77	0,61	0,73	0,80	24,7	23,4
12.5 / 9,3	15500	380	2850	22,0	74	0,79	0,80	0,78	0,71	0,80	0,84	31,1	25,9
		400	2870	21,4	78	0,78	0,79	0,78	0,64	0,76	0,82	31,0	29,0
		415	2880	21,2	81	0,76	0,79	0,78	0,60	0,72	0,80	30,9	31,4
15.0 / 11,0	15500	380	2860	25,8	93	0,78	0,80	0,78	0,71	0,80	0,85	36,7	31,5
		400	2880	25,2	98	0,77	0,80	0,79	0,65	0,76	0,83	36,4	35,3
		415	2890	25,1	102	0,75	0,78	0,79	0,61	0,73	0,80	36,3	38,2
17.5 / 13,0	15500	380	2860	30,1	118	0,80	0,81	0,80	0,68	0,79	0,84	43,1	45,0
		400	2900	29,6	125	0,78	0,80	0,80	0,61	0,74	0,81	42,8	50,3
		415	2900	29,7	130	0,76	0,79	0,80	0,57	0,70	0,78	42,7	54,6
20.0 / 15,0	15500	380	2860	33,9	140	0,81	0,82	0,81	0,71	0,81	0,85	49,7	53,9
		400	2890	33,1	148	0,79	0,81	0,81	0,65	0,77	0,83	49,4	60,4
		415	2900	33,0	151	0,77	0,80	0,81	0,60	0,73	0,81	49,3	65,5
25.0 / 18,5	15500	380	2860	42,3	172	0,81	0,82	0,81	0,68	0,78	0,84	61,7	75,2
		400	2880	42,0	182	0,78	0,81	0,81	0,61	0,74	0,80	61,2	84,3
		415	2890	42,5	189	0,76	0,79	0,80	0,57	0,70	0,77	61,1	91,3
30.0 / 22,0	15500	380	2880	49,1	218	0,82	0,84	0,83	0,68	0,78	0,84	72,6	91,2
		400	2900	49,0	231	0,80	0,82	0,82	0,61	0,73	0,80	72,5	102,2
		415	2910	49,6	240	0,77	0,81	0,82	0,56	0,69	0,77	72,2	110,7
35.0 / 26,0	15500	380	2880	57,5	268	0,83	0,84	0,83	0,68	0,79	0,86	86,0	120,4
		400	2900	56,7	284	0,81	0,83	0,83	0,61	0,74	0,83	85,6	134,7
		415	2910	57,3	296	0,78	0,82	0,82	0,56	0,69	0,80	85,3	146,1
40.0 / 30,0	27500	380	2900	66,4	328	0,82	0,84	0,83	0,67	0,78	0,84	98,8	135,0
		400	2910	66,4	347	0,80	0,83	0,83	0,60	0,73	0,80	98,4	151,0
		415	2910	67,5	361	0,77	0,81	0,82	0,55	0,68	0,77	98,2	163,0
50.0 / 37,0	27500	380	2890	82,0	409	0,83	0,84	0,83	0,67	0,78	0,84	122,1	192,8
		400	2900	81,9	433	0,80	0,83	0,83	0,60	0,72	0,80	121,6	215,8
		415	2910	83,9	450	0,77	0,81	0,82	0,55	0,68	0,76	121,3	234,0



STAINLESS STEEL SUBMERSIBLE PUMP

Material specification

No.	PART NAME	MATERIAL
1	N.R.V. 1.25"	SS AISI 304
2	VALVE	SS AISI 304
3	VALVE SEAT	N.B.R.
4	TOP BEARING HOUSING	SS AISI 304
5	TOP BEARING HOUSING BUSH	N.B.R.
6	TOP BEARING HOUSING SLEEVE	SS AISI 304
7	THRUST WASHER	SS AISI 304
8	TOP DIFFUSER	SS AISI 304
9	DIFFUSER	SS AISI 304
10	BEARING BUSH	N.B.R.
11	NECKRING	N.B.R. + P.P.S.
12	IMPELLER	SS AISI 304
13	STAGE SLEEVE	SS AISI 304
14	MIDDLE BEARING HOUSING	SS AISI 304
15	MIDDLE BEARING HOUSING BUSH	N.B.R. + S.S.304
16	MIDDLE BEARING HOUSING SLEEVE	SS AISI 304
17	PUMP SHAFT	SS AISI 431
18	FIRST STAGE DIFFUSER	SS AISI 304
19	STRAINER	SS AISI 304
20	NEMA COUPLING	SS AISI 304
21	SUCTION INTERCONNECTOR	SS AISI 304
22	CLAMPING STRIP	SS AISI 304
23	HEX NUT	A2-70 (316)
24	CABLE GUARD	SS AISI 304

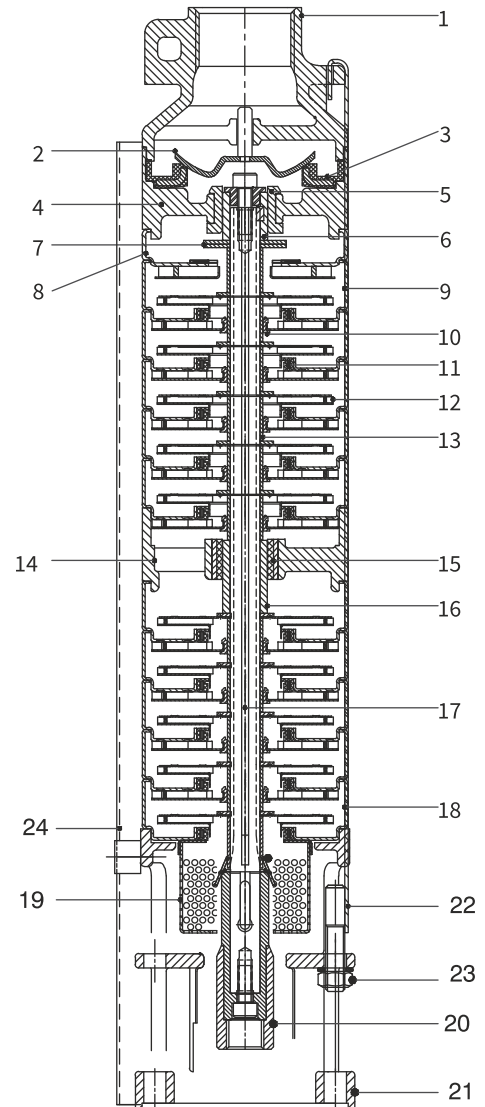

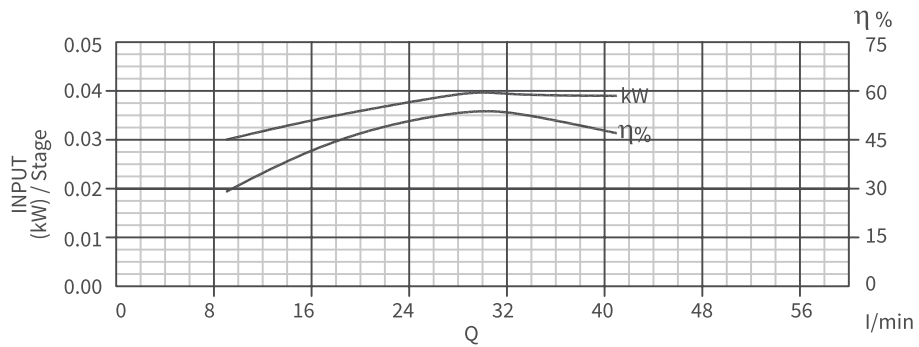
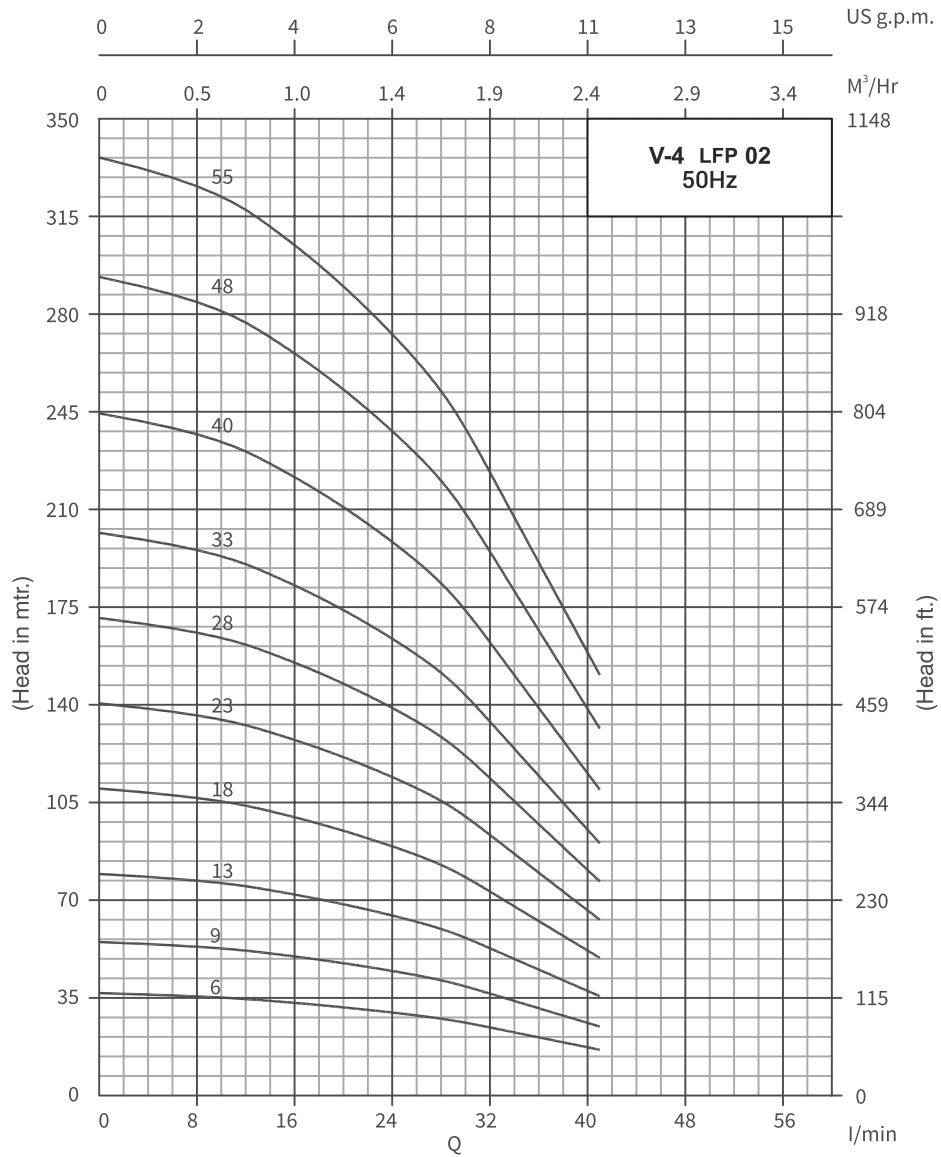

kW	HP	Stage	Motor Joinings	Outlet Size	Discharge						
					m ³ /h	0	1	1.4	2	2.4	2.7
					lpm	0	17	23	33	40	45
0.37	0.5	6	V-4	1½"	Head in Mtrs.	35	31	29	23	14	8
0.37	0.5	9	V-4	1½"		52	46	43	35	22	12
0.55	0.75	13	V-4	1½"		75	67	62	51	31	17
0.75	1	18	V-4	1½"		104	93	86	70	43	23
1.1	1.5	23	V-4	1½"		133	118	109	90	55	30
1.5	2	28	V-4	1½"		162	144	133	109	67	36
1.5	2	33	V-4	1½"		191	170	157	129	79	43
2.2	3	40	V-4	1½"		232	206	190	156	96	52
2.2	3	48	V-4	1½"		278	247	228	187	115	6
3	4	55	V-4	1½"		319	283	261	214	131	71

Dimensionseits

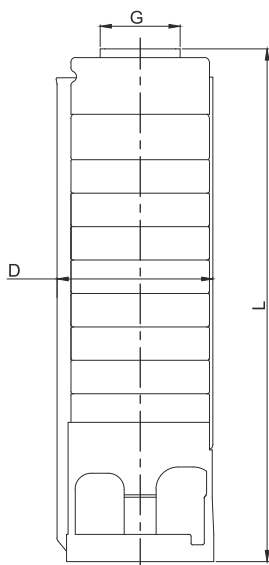

Model Name	Specification			
	D (mm)	L (mm)	Pump Weight Kg.	Weight (incl. pkg.) Kg.
V-4 LFP02 -06	98	280	3.2	3.8
V-4 LFP02 -09	98	343	4.2	5.1
V-4 LFP02 -13	98	427	5.4	6.7
V-4 LFP02 -18	98	532	7.2	9.0
V-4 LFP02 -23	98	668	8.9	11.2
V-4 LFP02 -28	98	773	10.6	13.4
V-4 LFP02 -33	98	878	12.2	15.5
V-4 LFP02 -40	98	1097	13.0	17.0
V-4 LFP02 -48	98	1296	14.6	19.44
V-4 LFP02 -55	98	1443	16.2	21.7

G: Available Outlet Size 1.25" BSP

D: With Cable Guard

LFP5 3-75 and LFP54 4-90 pump available in 4" Joining mounted sleeve.

Material specification

No.	PART NAME	MATERIAL
1	N.R.V. 1.25"	SS AISI 304
2	VALVE	SS AISI 304
3	VALVE SEAT	N.B.R.
4	TOP BEARING HOUSING	SS AISI 304
5	TOP BEARING HOUSING BUSH	N.B.R.
6	TOP BEARING HOUSING SLEEVE	SS AISI 304
7	THRUST WASHER	SS AISI 304
8	TOP DIFFUSER	SS AISI 304
9	DIFFUSER	SS AISI 304
10	BEARING BUSH	N.B.R.
11	NECKRING	N.B.R. + P.P.S.
12	IMPELLER	SS AISI 304
13	STAGE SLEEVE	SS AISI 304
14	MIDDLE BEARING HOUSING	SS AISI 304
15	MIDDLE BEARING HOUSING BUSH	N.B.R. + S.S.304
16	MIDDLE BEARING HOUSING SLEEVE	SS AISI 304
17	PUMP SHAFT	SS AISI 431
18	FIRST STAGE DIFFUSER	SS AISI 304
19	STRAINER	SS AISI 304
20	NEMA COUPLING	SS AISI 304
21	SUCTION INTERCONNECTOR	SS AISI 304
22	CLAMPING STRIP	SS AISI 304
23	HEX NUT	A2-70 (316)
24	CABLE GUARD	SS AISI 304

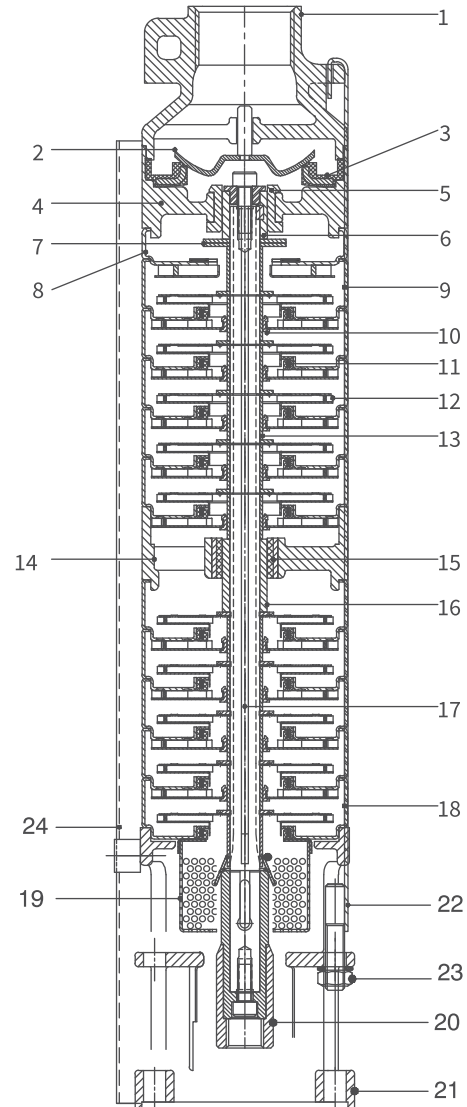

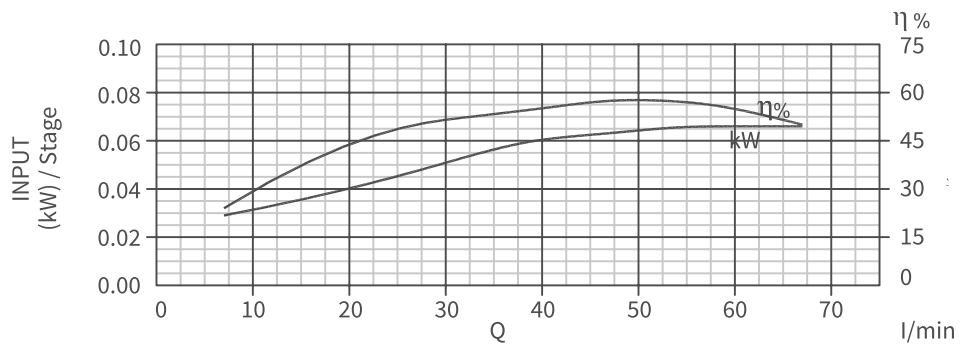
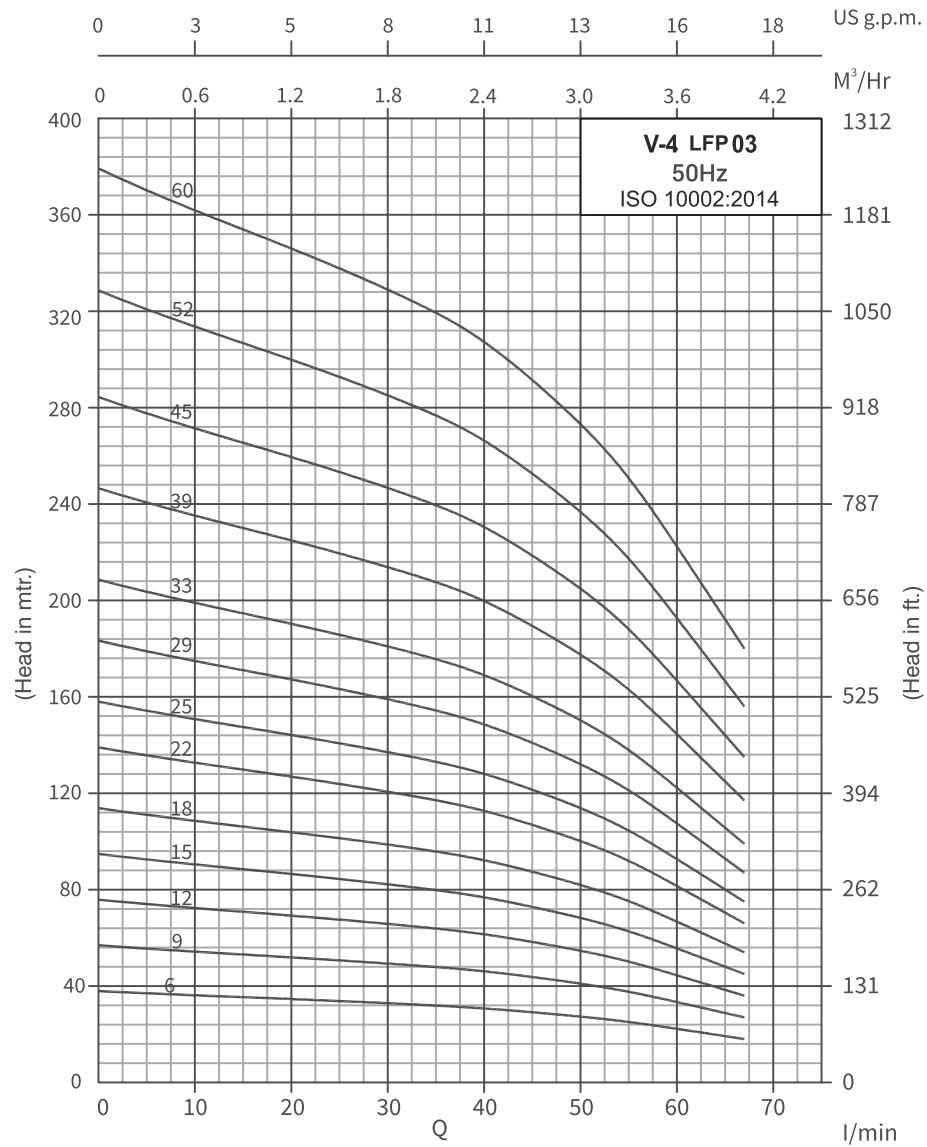

kW	HP	Stage	Motor Joinings	Outlet Size	Discharge						
					m ³ /h	0	1.8	2.4	3	3.6	4
					lpm	0	30	40	50	60	67
0.37	0.5	6	V-4	1 1/2"	Head in Mtrs.	36	32	30	26	20	16
0.55	0.75	9	V-4	1 1/2"		54	49	45	39	31	23
0.75	1	12	V-4	1 1/2"		72	65	60	52	41	31
1.1	1.5	15	V-4	1 1/2"		90	81	75	65	51	39
1.1	1.5	18	V-4	1 1/2"		108	97	90	78	61	47
1.5	2	22	V-4	1 1/2"		132	119	110	96	75	57
1.5	2	25	V-4	1 1/2"		150	135	125	109	85	65
2.2	3	29	V-4	1 1/2"		174	157	145	126	99	75
2.2	3	33	V-4	1 1/2"		198	178	165	144	112	86
3	4	39	V-4	1 1/2"		234	211	195	170	133	101
3	4	45	V-4	1 1/2"		270	243	225	196	153	117
3.7	5	52	V-4	1 1/2"		312	281	260	226	177	135
3.7	5	60	V-4	1 1/2"		360	324	300	260	204	155

Dimensionseits

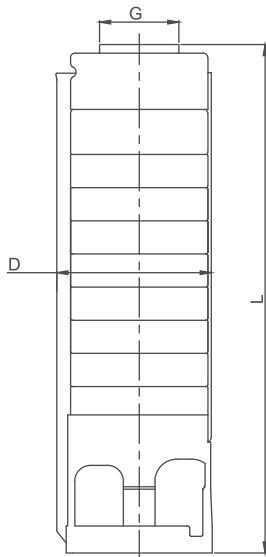

Model Name	Specification			
	D (mm)	L (mm)	Pump Weight Kg.	Weight (incl. pkg.) Kg.
V-4LFP03 -06	98	280	3.4	4.0
V-4LFP03 -09	98	343	4.4	5.3
V-4LFP03 -12	98	406	5.4	6.6
V-4LFP03 -15	98	469	6.4	7.9
V-4LFP03 -18	98	532	7.4	9.2
V-4LFP03 -22	98	647	8.7	10.9
V-4LFP03 -25	98	710	9.7	12.2
V-4LFP03 -29	98	794	10.9	13.8
V-4LFP03 -33	98	878	12.2	15.5
V-4LFP03 -39	98	1076	12.7	16.6
V-4LFP03 -45	98	1233	14.0	18.5
V-4LFP03 -52	98	1380	15.5	20.7
V-4LFP03 -60	98	1548	17.3	23.3

G: Available Outlet Size 1.25" BSP
 D: With Cable Guard

Material specification

No.	PART NAME	MATERIAL
1	N.R.V. 1.25"	SS AISI 304
2	VALVE	SS AISI 304
3	VALVE SEAT	N.B.R.
4	TOP BEARING HOUSING	SS AISI 304
5	TOP BEARING HOUSING BUSH	N.B.R.
6	TOP BEARING HOUSING SLEEVE	SS AISI 304
7	THRUST WASHER	SS AISI 304
8	TOP DIFFUSER	SS AISI 304
9	DIFFUSER	SS AISI 304
10	BEARING BUSH	N.B.R.
11	NECKRING	N.B.R. + P.P.S.
12	IMPELLER	SS AISI 304
13	STAGE SLEEVE	SS AISI 304
14	MIDDLE BEARING HOUSING	SS AISI 304
15	MIDDLE BEARING HOUSING BUSH	N.B.R. + S.S.304
16	MIDDLE BEARING HOUSING SLEEVE	SS AISI 304
17	PUMP SHAFT	SS AISI 431
18	FIRST STAGE DIFFUSER	SS AISI 304
19	STRAINER	SS AISI 304
20	NEMA COUPLING	SS AISI 304
21	SUCTION INTERCONNECTOR	SS AISI 304
22	CLAMPING STRIP	SS AISI 304
23	HEX NUT	A2-70 (316)
24	CABLE GUARD	SS AISI 304

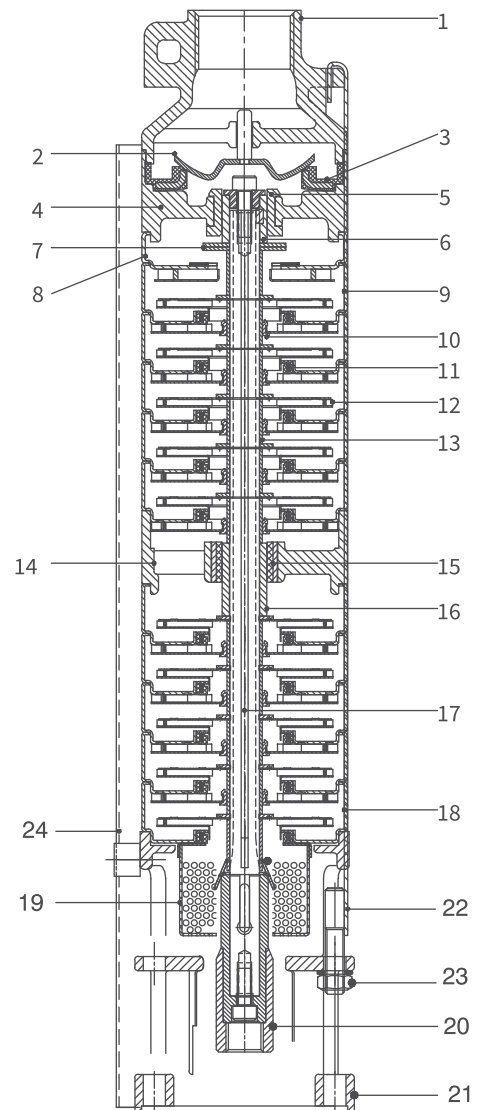

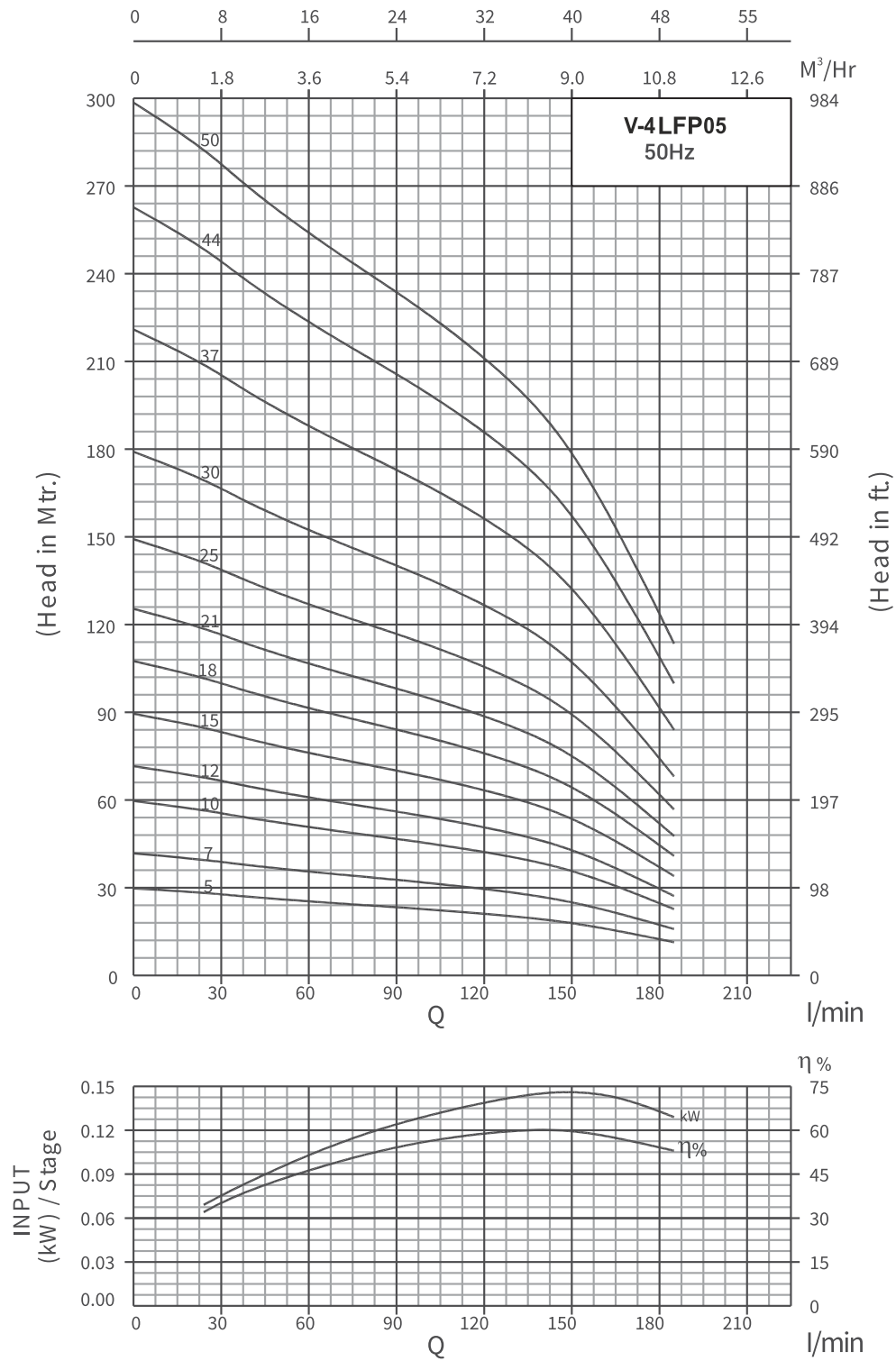

V-4 LFP5 50Hz SERIES PUMP DESIGN

kW	HP	Stage	Motor Joinings	Outlet Size	Discharge						
					m ³ /h	0	2.4	3.4	4	5	6
					lpm	0	40	57	67	83	100
0.37	0.5	4	V-4	1½"	Head in Mtrs.	24	21	20	19	16	12
0.55	0.75	6	V-4	1½"		36	32	30	28	24	17
0.75	1	8	V-4	1½"		48	42	40	38	32	23
1.1	1.5	12	V-4	1½"		72	63	60	56	48	35
1.5	2	17	V-4	1½"		102	89	85	80	68	49
2.2	3	21	V-4	1½"		126	110	105	99	84	61
2.2	3	25	V-4	1½"		150	131	125	118	100	73
3	4	33	V-4	1½"		198	173	165	155	132	96
3.7	5	38	V-4	1½"		228	200	190	179	152	110
4.5	6	44	V-4	1½"		264	231	220	207	176	128
5.5	7.5	52	V-4	1½"		312	273	260	244	208	151
5.5	7.5	60	V-4	1½"		360	315	300	281	240	174
7.5	10	75	V-4	1½"		450	394	375	351	300	217
7.5	10	85	V-4	1½"		510	446	425	398	340	246

Dimensionseits

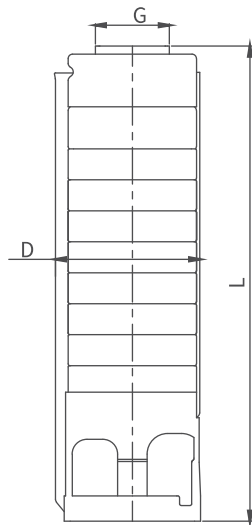

Model Name	Specification			
	D (mm)	L (mm)	Pump Weight Kg.	Weight (incl. pkg.) Kg.
V-4LFP05 -04	98	238	3.2	3.4
V-4LFP05 -06	98	280	3.6	3.9
V-4LFP05 -08	98	322	4.0	4.4
V-4LFP05 -12	98	406	5.6	6.2
V-4LFP05 -15	98	469	6.6	7.4
V-4LFP05 -17	98	511	7.0	7.9
V-4LFP05 -21	98	626	8.4	9.5
V-4LFP05 -25	98	710	9.7	11.0
V-4LFP05 -33	98	878	12.5	14.2
V-4LFP05 -38	98	1169	13.0	14.7
V-4LFP05 -44	98	1344	14.0	16.0
V-4LFP05 -52	98	1536	16.3	18.6
V-4LFP05 -60	119	1820	27.0	22.4
V-4LFP05 -75	144	2423	43.5	26.1
V-4LFP05 -85	144	2694	47.5	30.5

G: Available Outlet Size 1.5" BSP

D: With Cable Guard

LFP5 -52 & LFP5-60 pump available in 6" Joining

LFP5 -75 & LFP5-85 pump available in 6" Joining with mounted sleeve.

V-4 LFP5 50Hz SERIES PUMP DESIGN

Material specification

No.	PART NAME	MATERIAL
1	N.R.V. 2.0"	SS AISI 304
2	VALVE	SS AISI 304
3	TOP BEARING BUSH	N.B.R.
4	TOP DIFFUSER	SS AISI 304
5	COLLET & COLLET NUT	SS AISI 304
6	IMPELLER	SS AISI 304
7	NECKRING	N.B.R. + NYLON
8	DIFFUSER	SS AISI 304
9	BEARING BUSH	N.B.R.
9	STAGE SLEEVE	SS AISI 304
10	PUMP SHAFT	S.S. AISI 431
11	CLAMPING STRIP	SS AISI 304
12	STRAINER	SS AISI 304
13	NEMA COUPLING	SS AISI 304
14	CABLE GUARD	SS AISI 304
15	SUCTION	SS AISI 304

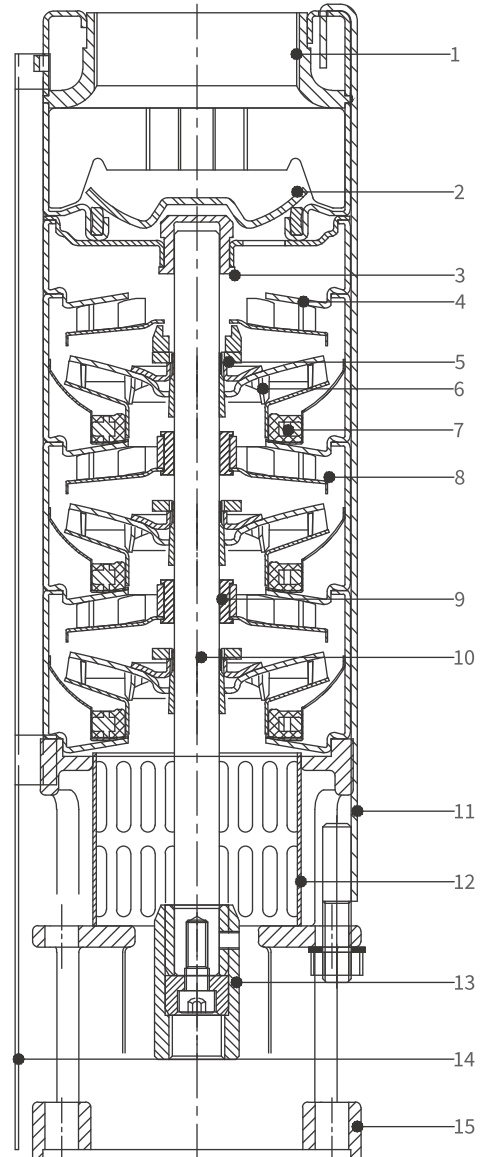

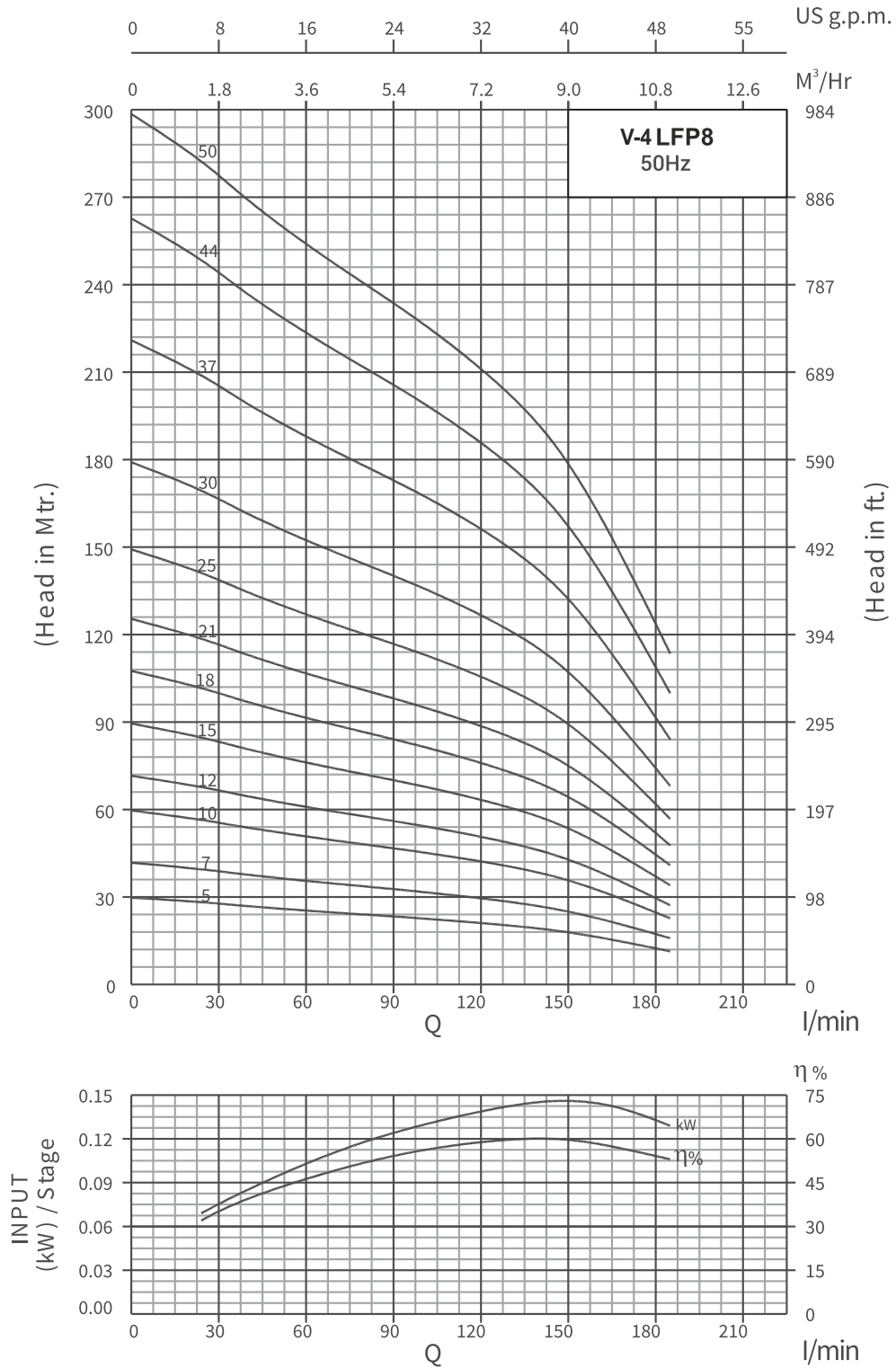

kW	HP	Stage	Motor Joinings	Outlet Size	Discharge						
					m ³ /h	0	4	6	8	9	10
					lpm	0	67	100	133	150	167
0.75	1	5	V-4	2"	Head in Mtrs.	30	24	23	20	18	14
1.1	1.5	7	V-4	2"		42	34	32	28	25	20
1.5	2	10	V-4	2"		60	48	45	40	36	28
2.2	3	12	V-4	2"		72	58	54	48	43	34
2.2	3	15	V-4	2"		90	72	68	60	54	42
3	4	18	V-4	2"		108	86	81	72	65	50
3.7	5	21	V-4	2"		126	101	95	84	76	59
4.5	6	25	V-4	2"		150	120	113	100	90	70
5.5	7.5	30	V-4	2"		180	144	135	120	108	84
5.5	7.5	37	V-4	2"		222	178	167	148	133	104
7.5	10	44	V-4	2"		264	211	198	176	158	123
7.5	10	50	V-4	2"		300	240	225	200	179	140

Dimensionseits

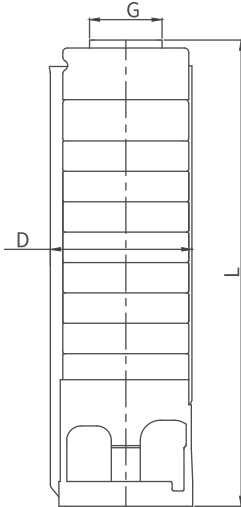

Model Name	Specification			
	D (mm)	L (mm)	Pump Weight Kg.	Weight (incl. pkg.) Kg.
V-4LFP08 -05	98	410	7.2	10.2
V-4LFP08 -07	98	494	7.7	10.7
V-4LFP08 -10	98	620	8.4	11.4
V-4LFP08 -12	98	704	8.9	11.9
V-4LFP08 -15	98	830	9.7	12.7
V-4LFP08 -18	98	956	10.5	13.5
V-4LFP08 -21	98	1082	11.2	14.2
V-4LFP08 -25	98	1250	12.3	15.3
V-4LFP08 -30	98	1460	13.5	16.5
V-4LFP08 -37	98	1754	15.3	18.3
V-4LFP08 -44	98	2048	17.1	20.1
V-4LFP08 -50	98	2300	18.8	21.8

G: Available Outlet Size BSP 2.0"
 D: With Cable Guard
 LFP8-30, LFP8-37, LFP8-44 & LFP8-50 pump are also available in 6" Joining.
 LFP8-58, LFP8-66, LFP8-73 & LFP8-82 LFP8-91, LFP8-100 & LFP8-110 Pump are also available in 6" Joining with mounted sleeve.

Material specification

No.	PART NAME	MATERIAL
1	N.R.V. 2.0"	S.S AISI 304
2	VALVE	SS AISI 304
3	TOP BEARING BUSH	N.B.R.
4	TOP DIFFUSER	SS AISI 304
5	COLLET & COLLET NUT	SS AISI 304
6	IMPELLER	SS AISI 304
7	NECKRING	N.B.R. + NYLON
8	DIFFUSER	SS AISI 304
9	BEARING BUSH	N.B.R.
10	PUMP SHAFT	SS AISI 431
11	CLAMPING STRIP	SS AISI 304
12	STRAINER	SS AISI 304
13	NEMA COUPLING	SS AISI 304
14	CABLE GUARD	SS AISI 304
15	SUCTION	SS AISI 304

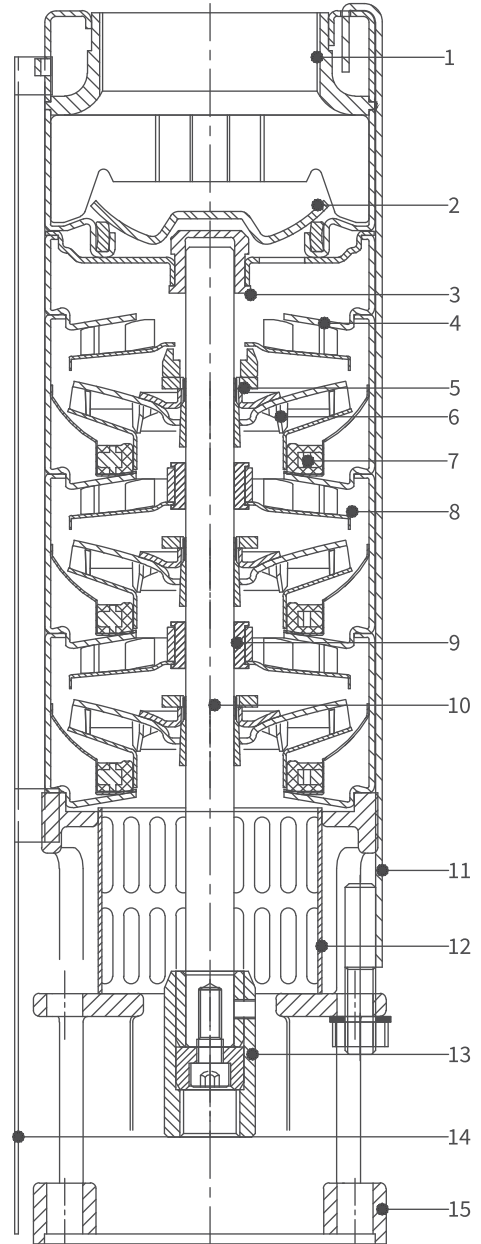

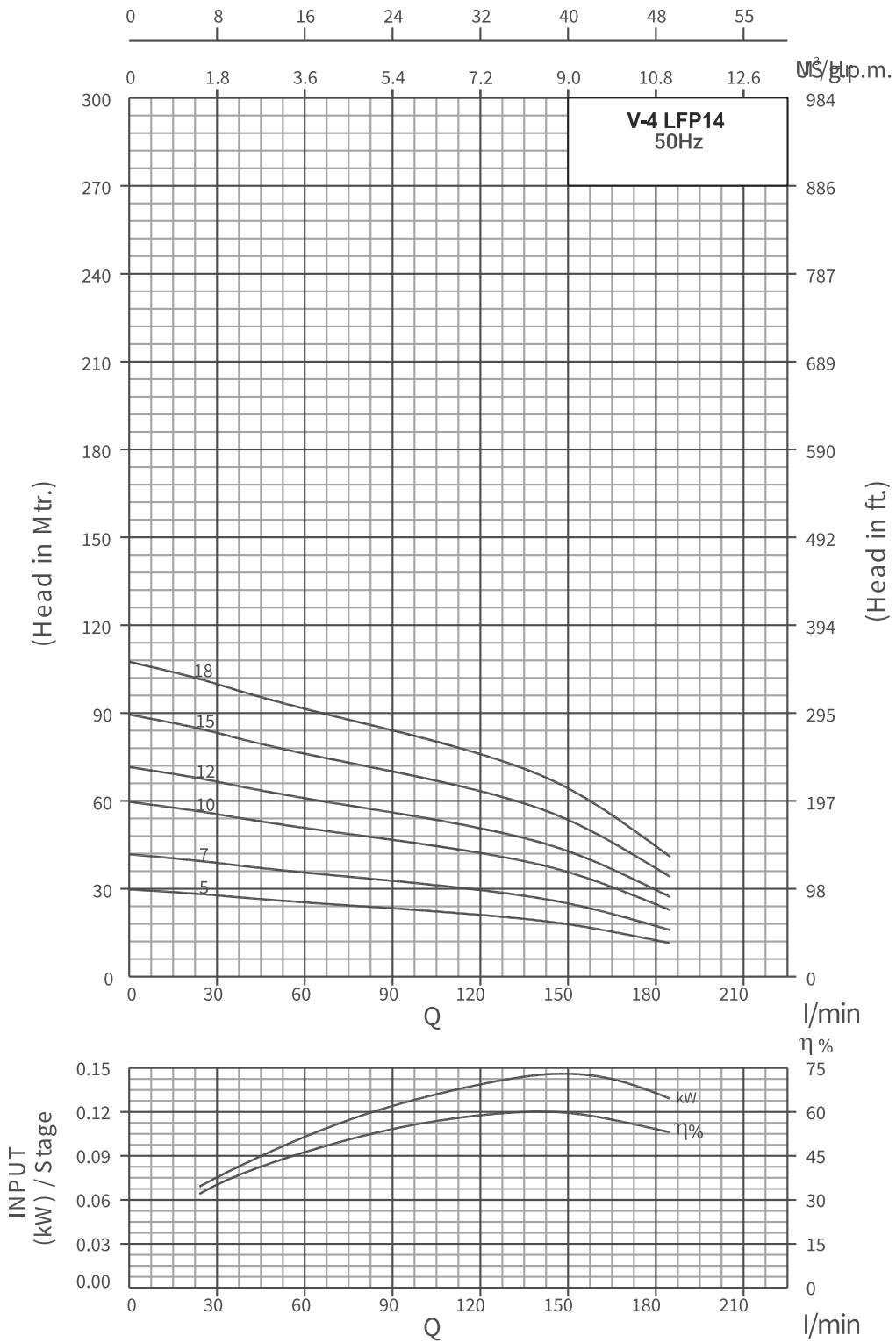

KW	HP	Stage	Motor Joinings	Outlet Size	m3/h	Discharge				
						0	6	9	11	12
					lpm	0	100	150	184	200
1.1	1.5	5	V-4	2"	Head in Mtrs.	30	24	18	12	9
1.5	2	7	V-4	2"		42	32	24	18	15
2.2	3	10	V-4	2"		60	45	36	24	21
3	4	12	V-4	2"		72	54	42	30	27
4	5.5	15	V-4	2"		90	72	54	36	33
5.5	7.5	18	V-4	2"		118	84	66	42	39

Dimensionseits

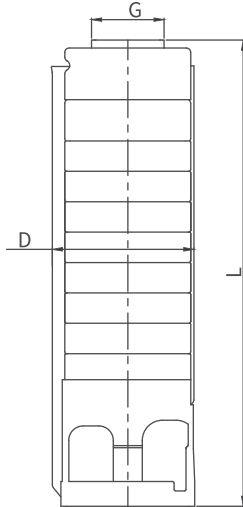

Model Name	Specifications			
	D (mm)	L (mm)	Pump Weight Kg.	Weight (inc.pkg.) Kg.
V4OMP14 -05	98	570	7.2	10.2
V4OMP14 -07	98	700	7.7	10.7
V4OMP14 -10	98	895	8.4	11.4
V4OMP14 -12	98	1155	8.9	11.9
V4OMP14 -15	98	1480	9.7	12.7
V4OMP14 -18	98	2000	10.5	13.5

G: Available Outlet Size BSP 2.0"

D: With Cable Guard

LFP14 -18 pump are also available in 6" Joining.

Performance Curve

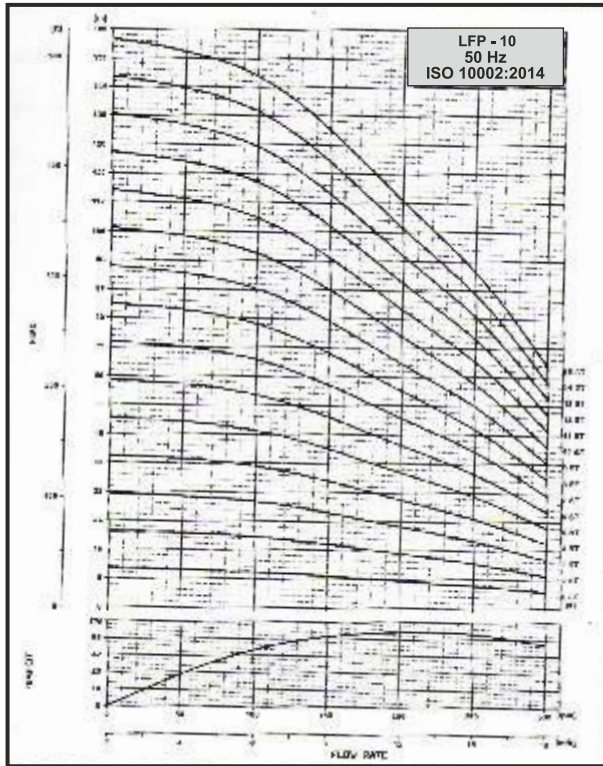

Performance Curve

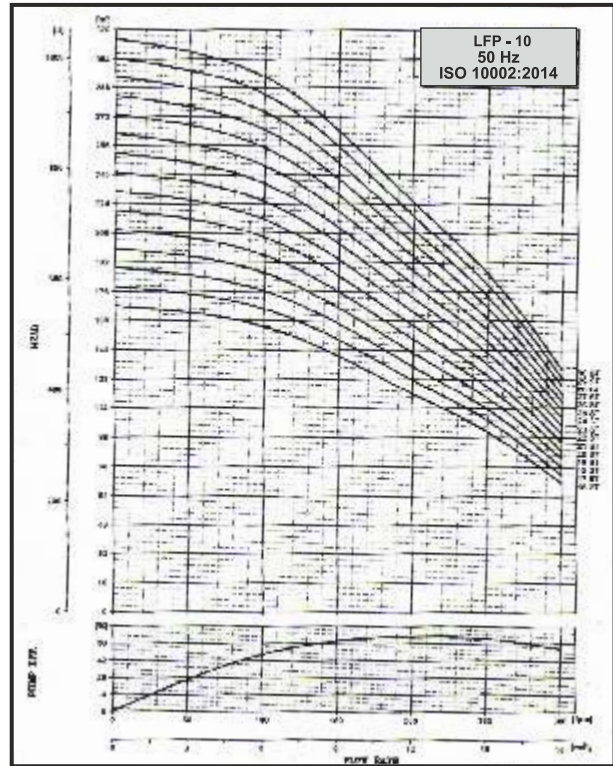

Power Curve

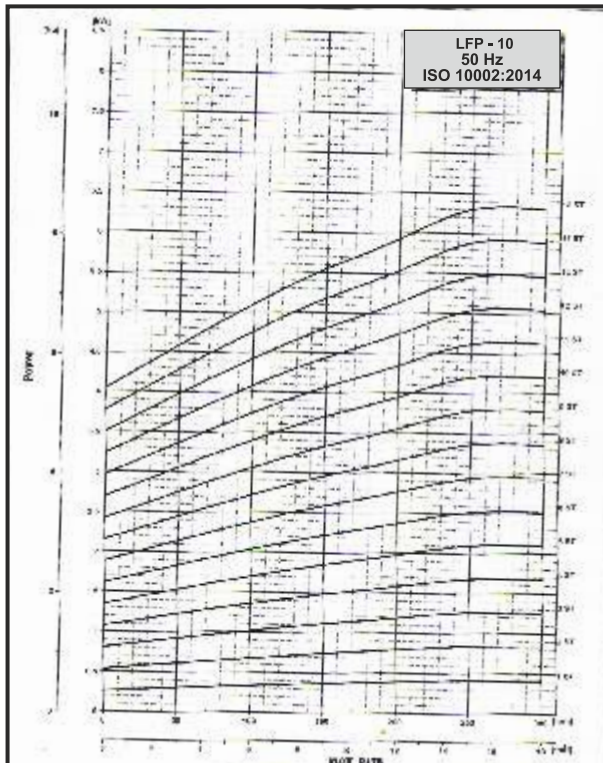

Power Curve

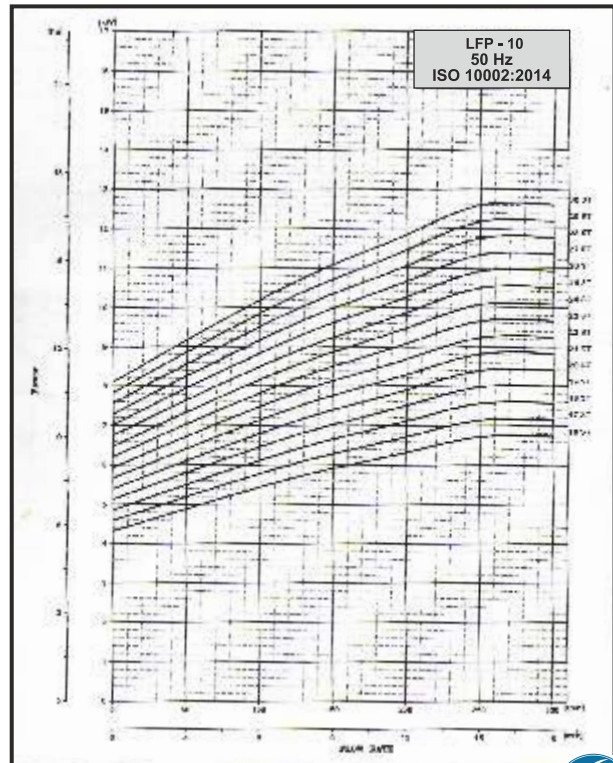

Dimensions, Weights and Performance Table

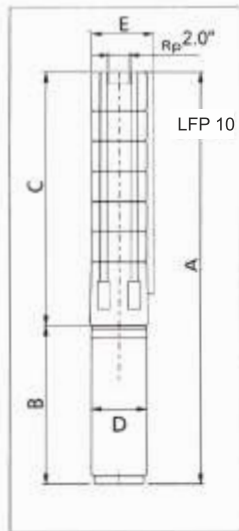

Model - Stage	m ³ / hrs Ltr / Min. Motor kw / HP	Discharges (Q)					Dimensions in (mm) Rp				Pump Net Weight In Kgs
		6	8	10	12	14	2.0" Thread Connection				
		100	133	167	200	233	C	A	D*	E**	
		Total Head in Meters									
LFP 10-1	0.55 / 0.75	12	10	8	7	6	318	670	95	131	8
LFP 10-2	1.1 / 1.5	22	20	17	14	13	378	760	95	131	10
LFP 10-3	1.5 / 2.0	32	30	28	21	19	439	800	95	131	11
LFP 10-4	2.2 / 3.0	39	38	36	28	25	499	952	95	131	12
LFP 10-5	2.2 / 3.0	49	46	42	35	32	560	1013	95	131	13
LFP 10-6	3.0 / 4.0	58	54	50	48	38	620	1112	95	131	15
LFP 10-7	3.0 / 4.0	69	66	58	55	44	681	1173	95	131	16
LFP 10-8	3.7 / 5.0	78	76	70	60	51	741	1313	95	131	17
LFP 10-9	4.0 / 5.5	84	83	78	68	57	802	1374	95	131	18
LFP 10-10	4.0 / 5.5	98	94	86	76	63	879	1434	95	131	19
LFP 10-11	5.5 / 7.5	105	102	96	84	70	940	1462	145	145	21
LFP 10-12	5.5 / 7.5	118	114	102	90	76	1000	1522	145	145	22
LFP 10-13	5.5 / 7.5	127	120	110	98	82	1061	1614	145	145	23
LFP 10-14	7.5 / 10.0	137	134	120	106	89	1121	1690	145	145	24
LFP 10-15	7.5 / 10.0	147	144	126	115	95	1182	1751	145	145	26
LFP 10-16	7.5 / 10.0	157	151	134	121	101	1242	1811	145	145	27
LFP 10-17	7.5 / 10.0	167	158	140	129	108	1303	1902	145	145	28
LFP 10-18	7.5 / 10.0	177	166	148	136	114	1363	1962	145	145	29
LFP 10-19	9.2 / 12.5	186	172	158	144	120	1424	2029	145	145	31
LFP 10-20	9.2 / 12.5	196	180	166	151	127	1484	2083	145	145	32
LFP 10-21	9.2 / 12.5	206	195	178	159	133	1545	2175	145	145	33
LFP 10-22	9.2 / 12.5	216	202	185	167	139	1605	2235	145	145	34
LFP 10-23	11.0 / 15.0	224	210	190	174	146	1666	2296	145	145	35
LFP 10-24	11.0 / 15.0	234	220	200	182	152	1726	2356	145	145	37
LFP 10-25	11.0 / 15.0	244	230	208	189	158	1787	2448	145	145	38
LFP 10-26	11.0 / 15.0	255	239	216	197	165	1847	2508	145	145	39
LFP 10-27	13.0 / 17.5	263	246	225	204	171	1908	2567	145	145	40
LFP 10-28	13.0 / 17.5	273	256	233	212	177	1968	2627	145	145	42
LFP 10-29	13.0 / 17.5	285	265	242	220	184	2029	2722	145	145	43
LFP 10-30	13.0 / 17.5	295	273	250	227	190	2089	2783	145	145	44
LFP 10-31	13.0 / 17.5	305	282	258	235	196	2150	2823	145	145	45
LFP 10-32	15.0 / 20.0	315	290	267	242	203	2210	2903	145	145	47
LFP 10-33	15.0 / 20.0	325	300	276	250	209	2271	2964	145	145	48
LFP 10-34	15.0 / 20.0	335	310	284	257	215	2331	3080	145	145	49
LFP 10-35	15.0 / 20.0	343	320	292	265	222	2392	3140	145	145	50
LFP 10-36	15.0 / 20.0	352	330	300	273	228	2452	3200	145	145	51
LFP 10-37	18.5 / 25.0	362	340	309	280	234	2513	3262	145	145	53
LFP 10-38	18.5 / 25.0	372	348	318	288	241	2573	3322	145	145	54
LFP 10-39	18.5 / 25.0	381	357	325	295	247	2633	3383	145	145	55
LFP 10-40	18.5 / 25.0	391	366	332	303	253	2693	3443	145	145	56
LFP 10-41	18.5 / 25.0	400	372	342	310	260	2753	3503	145	145	60
LFP 10-42	18.5 / 25.0	410	382	350	318	266	2813	3621	145	145	63
LFP 10-43	18.5 / 25.0	320	392	360	326	272	2873	3681	145	145	66
LFP 10-44	18.5 / 25.0	430	401	368	333	279	2933	3741	145	145	70

* Motor type / size may change as per requirement.
 ** Maximum diameter of pump with two cable guard.



Performance Curve

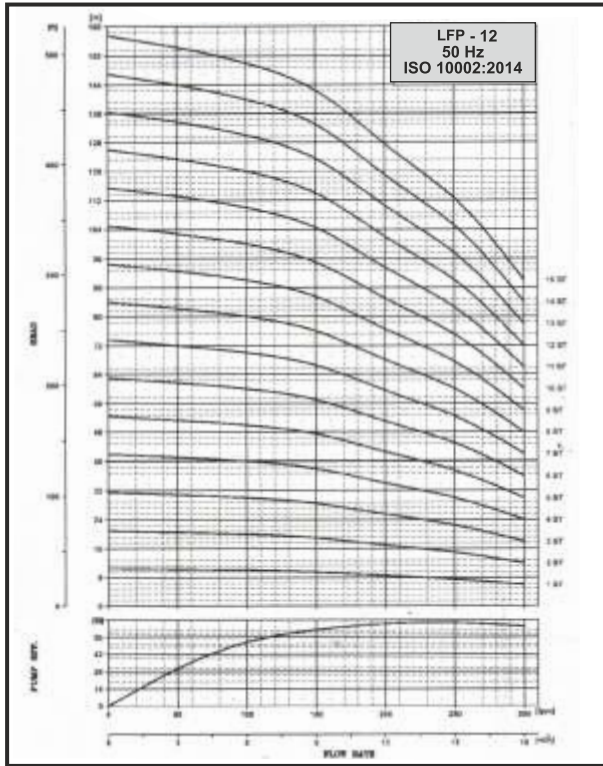

Performance Curve

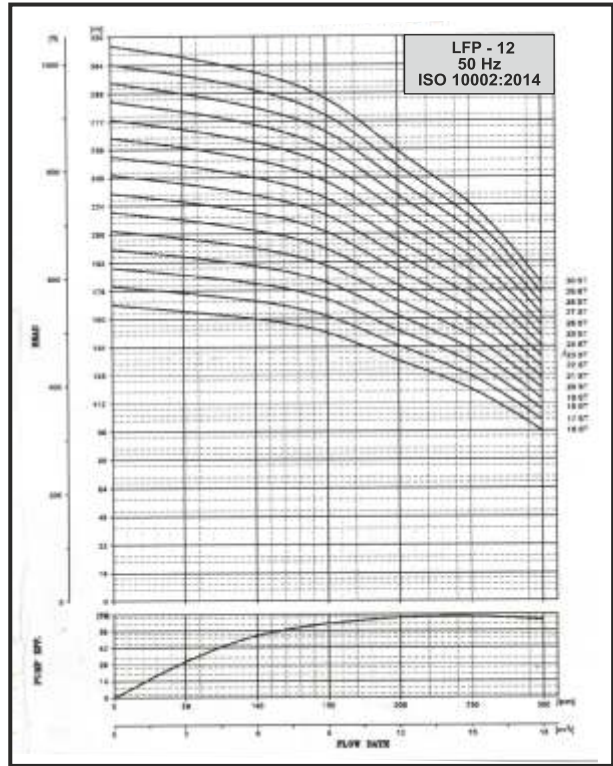

Power Curve

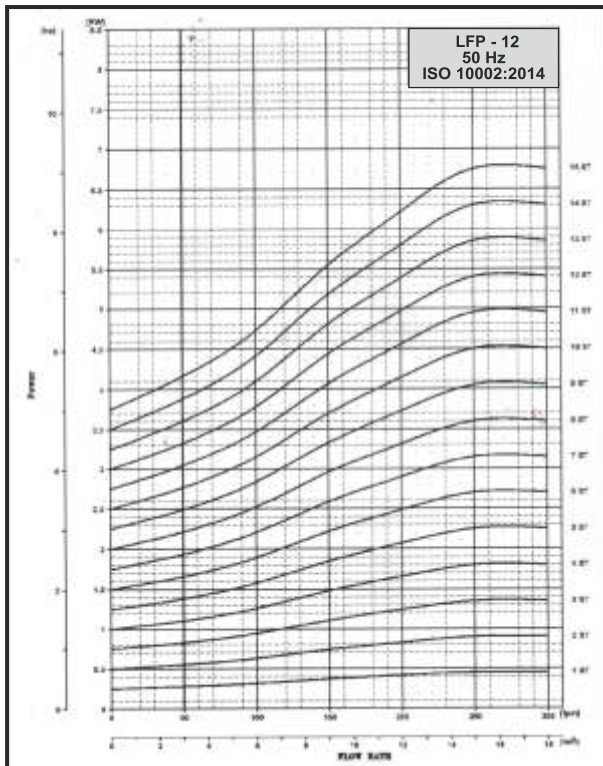

Power Curve

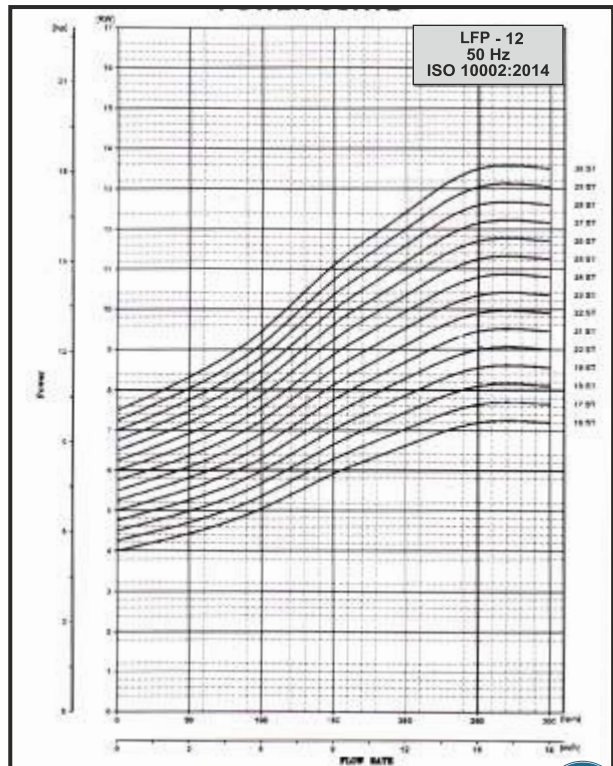

Dimension, Weight & Performance Table

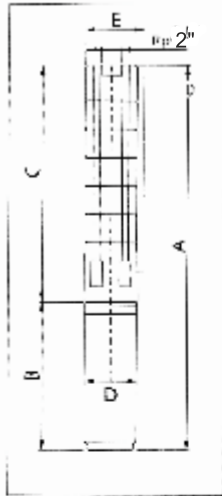

Model - Stage	Discharges (Q)					Dimensions in (mm)				Pump Net Weight In Kgs	
	m ³ / hrs Ltr / Min.	8	10	12	14	Rp 2" Thread Connection					
	Motor kw / HP	Total Head In Meters					C	A	D*		E**
LFP 12 - 1	0.55 / 0.75	10	10	9	8	6	318	670	95	131	8
LFP 12 - 2	1.1 / 1.5	19	18	17	15	13	378	760	95	131	10
LFP 12 - 3	1.5 / 2.0	29	27	26	23	19	439	800	95	131	11
LFP 12 - 4	2.2 / 3.0	38	36	34	30	26	499	952	95	131	12
LFP 12 - 5	2.7 / 3.0	48	45	43	38	33	560	1013	95	131	13
LFP 12 - 5	3.0 / 4.0	57	54	51	45	39	620	1112	95	131	15
LFP 12 - 7	3.0 / 4.0	67	63	60	53	46	681	1173	95	131	16
LFP 12 - 8	3.7 / 5.0	76	72	69	60	52	741	1313	95	131	17
LFP 12 - 9	4.0 / 5.5	86	81	77	68	58	802	1374	95	131	18
LFP 12 - 10	4.0 / 5.5	95	90	85	75	65	879	1434	95	131	19
LFP 12 - 11	5.5 / 7.5	105	99	94	83	72	940	1462	145	145	21
LFP 12 - 12	5.5 / 7.5	114	108	102	90	78	1000	1522	145	145	22
LFP 12 - 13	5.5 / 7.5	124	117	111	98	85	1061	1614	145	145	23
LFP 12 - 14	7.5 / 10.0	133	126	119	105	92	1121	1690	145	145	24
LFP 12 - 15	7.5 / 10.0	143	135	128	113	98	1182	1751	145	145	26
LFP 12 - 16	7.5 / 10.0	152	144	136	120	104	1242	1811	145	145	27
LFP 12 - 17	7.5 / 10.0	152	153	145	128	111	1303	1902	145	145	28
LFP 12 - 18	9.2 / 12.5	171	162	153	135	118	1363	1962	145	145	29
LFP 12 - 19	9.2 / 12.5	181	171	162	143	124	1424	2029	145	145	31
LFP 12 - 20	9.2 / 12.5	190	180	170	150	131	1484	2083	145	145	32
LFP 12 - 21	9.2 / 12.5	200	189	179	158	136	1545	2175	145	145	33
LFP 12 - 22	11.0 / 15.0	209	198	187	165	142	1505	2235	145	145	34
LFP 12 - 23	11.0 / 15.0	219	207	196	173	150	1566	2296	145	145	35
LFP 12 - 24	11.0 / 15.0	228	216	204	180	158	1726	2356	145	145	37
LFP 12 - 25	11.0 / 15.0	238	225	213	188	163	1787	2448	145	145	38
LFP 12 - 26	13.0 / 17.5	247	234	221	195	170	1847	2506	145	145	39
LFP 12 - 27	13.0 / 17.5	257	243	230	203	177	1908	2567	145	145	40
LFP 12 - 28	13.0 / 17.5	266	252	238	210	183	1968	2627	145	145	42
LFP 12 - 29	13.0 / 17.5	276	261	347	216	190	2029	2722	145	145	43
LFP 12 - 30	15.0 / 20.0	285	270	255	225	196	2089	2782	145	145	44
LFP 12 - 31	15.0 / 20.0	295	279	264	233	202	2150	2843	145	145	45
LFP 12 - 32	15.0 / 20.0	304	288	274	240	210	2210	2903	145	145	47
LFP 12 - 33	15.0 / 20.0	314	297	281	248	217	2271	2964	145	145	48
LFP 12 - 34	15.0 / 20.0	323	306	289	255	222	2331	3080	145	145	49
LFP 12 - 35	18.5 / 25.0	333	315	298	263	230	2392	3141	145	145	50
LFP 12 - 36	18.5 / 25.0	342	324	306	270	235	2452	3201	145	145	51
LFP 12 - 37	18.5 / 25.0	352	333	315	278	242	2513	3262	145	145	53
LFP 12 - 38	18.5 / 25.0	351	342	323	285	248	2573	3322	145	145	54
LFP 12 - 39	18.5 / 25.0	371	351	332	293	255	2633	3383	145	145	55
LFP 12 - 40	18.5 / 25.0	380	360	340	300	262	2693	3443	145	145	56
LFP 12 - 41	18.5 / 25.0	389	369	348	307	268	2753	3530	145	145	60
LFP 12 - 42	18.5 / 25.0	399	378	357	315	275	2813	3621	145	145	63
LFP 12 - 43	22.0 / 30.0	418	387	365	322	281	2873	3661	145	145	66
LFP 12 - 44	22.0 / 30.0	418	396	374	330	288	2933	3721	145	145	70

* Motor type / size may change as per requirement.
 ** Maximum diameter of pump with two cable guard.



Performance Curve

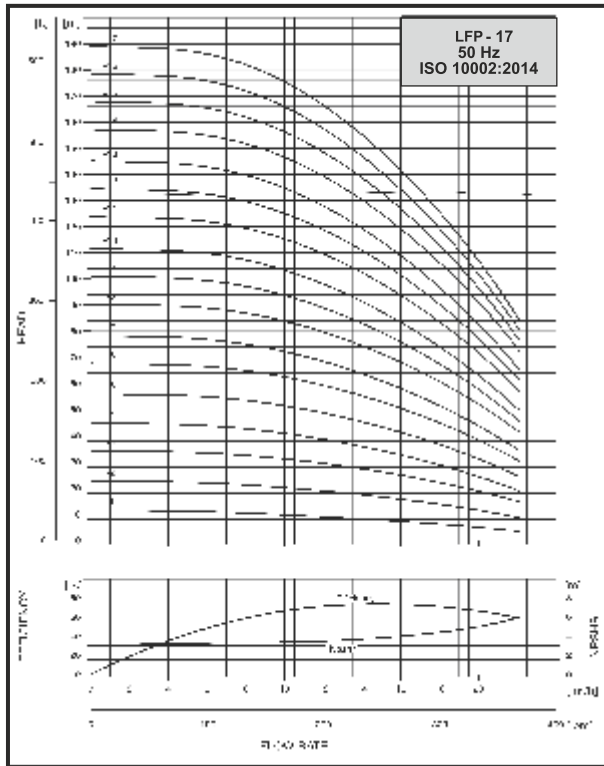

Performance Curve

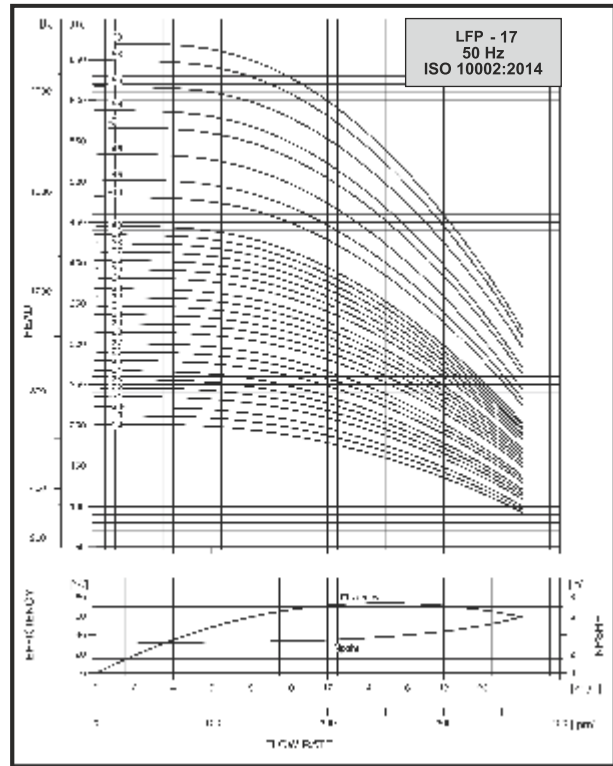

Power Curve

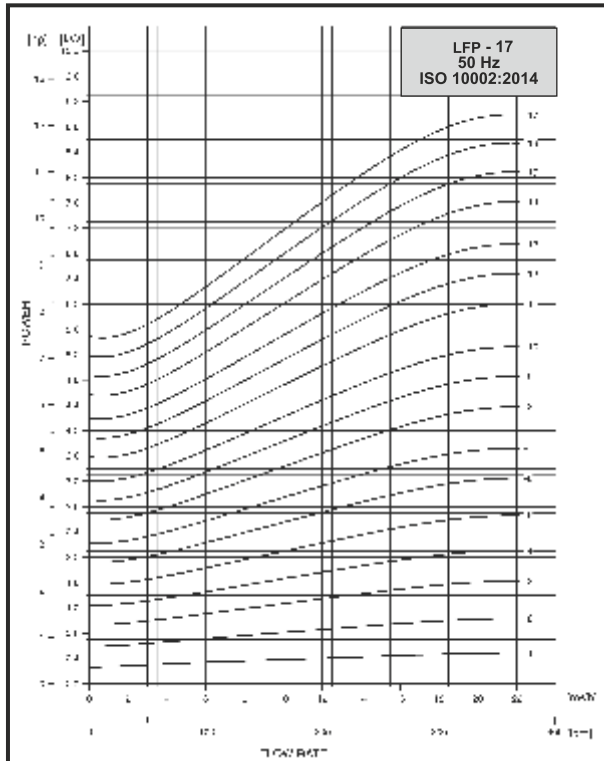

Power Curve

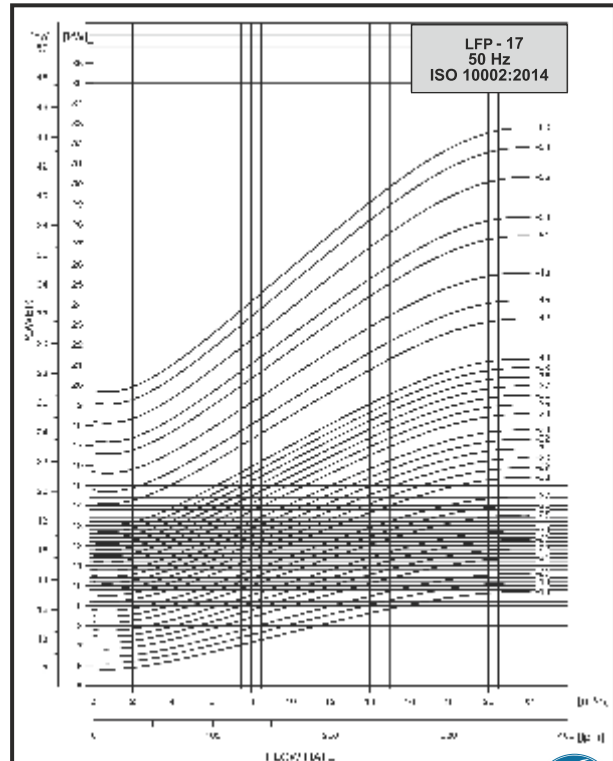

Dimensions, Weights and Performance Table

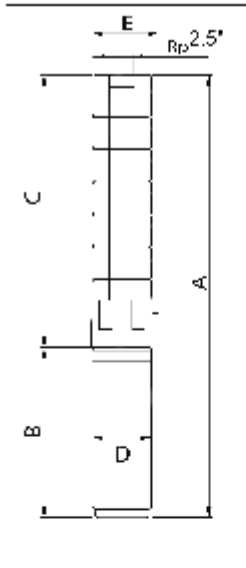

LFP 17 - 43 to LFP 17 - 60 pumps are mounted in S.S. Slocco.

Model-Stage	m ³ / hrs Llr / Min. Motor kw / HP	Discharges (Q)					Dimensions in (mm)				Pump Net Weight In Kgs
		12	14	16	18	20	Rp 2.5" Thread Connection				
		200	233	267	300	333	C	A	D*	E**	
		Total Head in Meters									
LFP 17 - 1	0.55 / 0.75	9	8	7	6	5	314	558	95	131	/
LFP 17 - 2	1.1 / 1.5	19	17	16	14	12	371	683	95	131	9
LFP 17 - 3	2.2 / 3.0	29	27	25	22	19	435	783	95	131	10
LFP 17 - 4	3.3 / 3.0	39	36	33	29	24	495	843	95	131	11
LFP 17 - 5	3 / 4.0	49	45	41	37	31	556	1052	95	131	12
LFP 17 - 6	4 / 5.5	59	55	50	45	38	616	1192	95	131	14
LFP 17 - 7	4 / 5.5	68	64	58	52	44	677	1253	95	131	15
LFP 17 - 8	5.5 / 7.5	80	74	68	61	52	737	1412	95	131	16
LFP 17 - 9	5.5 / 7.5	89	83	76	67	58	798	1473	95	131	17
LFP 17 - 10	5.5 / 7.5	98	91	83	74	63	858	1533	95	131	18
LFP 17 - 11	7.5 / 10	110	102	94	84	72	919	1696	95	131	20
LFP 17 - 12	7.5 / 10	119	111	101	90	77	979	1756	95	131	21
LFP 17 - 13	7.5 / 10	128	119	109	97	83	1040	1817	95	131	22
LFP 17 - 8	5.5 / 7.5	80	74	68	61	52	737	1280	145	143	16
LFP 17 - 9	5.5 / 7.5	89	83	76	67	58	798	1341	145	143	17
LFP 17 - 10	5.5 / 7.5	98	91	83	74	63	858	1401	145	143	18
LFP 17 - 11	7.5 / 10	110	102	94	84	72	919	1493	145	143	20
LFP 17 - 12	7.5 / 10	119	111	101	90	77	979	1553	145	143	21
LFP 17 - 13	7.5 / 10	128	119	109	97	83	1040	1614	145	143	22
LFP 17 - 14	9.2 / 12.5	139	130	119	106	91	1116	1720	145	143	23
LFP 17 - 15	9.2 / 12.5	149	139	127	113	97	1177	1781	145	143	25
LFP 17 - 16	9.2 / 12.5	158	147	134	119	102	1237	1841	145	143	26
LFP 17 - 17	9.2 / 12.5	166	155	141	126	107	1298	1902	145	143	27
LFP 17 - 18	11 / 15	178	167	152	136	116	1358	1993	145	143	28
LFP 17 - 19	11 / 15	187	175	160	142	121	1419	2054	145	143	30
LFP 17 - 20	11 / 15	196	183	167	148	126	1479	2114	145	143	31
LFP 17 - 21	13 / 17.5	209	195	179	159	137	1540	2204	145	143	32
LFP 17 - 22	13 / 17.5	218	204	186	166	142	1600	2264	145	143	33
LFP 17 - 23	13 / 17.5	227	212	193	172	147	1661	2325	145	143	34
LFP 17 - 24	13 / 17.5	236	220	201	178	152	1721	2385	145	143	36
LFP 17 - 25	15 / 20	248	232	212	189	162	1782	2480	145	143	37
LFP 17 - 26	15 / 20	257	240	220	196	168	1842	2540	145	143	38
LFP 17 - 27	15 / 20	266	249	227	202	173	1903	2601	145	143	39
LFP 17 - 28	18.5 / 25	281	263	241	215	186	1963	2717	145	143	41
LFP 17 - 29	18.5 / 25	290	272	249	222	191	2024	2778	145	143	42
LFP 17 - 30	18.5 / 25	299	280	257	229	197	2084	2838	145	143	43
LFP 17 - 31	18.5 / 25	309	289	264	236	202	2145	2899	145	143	44
LFP 17 - 32	18.5 / 25	318	297	272	242	208	2205	2959	145	143	46
LFP 17 - 33	18.5 / 25	327	305	279	249	213	2266	3020	145	143	47
LFP 17 - 34	22 / 30	340	318	291	260	223	2326	3138	145	143	48
LFP 17 - 35	22 / 30	349	326	299	266	229	2387	3199	145	143	49
LFP 17 - 36	22 / 30	358	335	306	273	234	2447	3259	145	143	50
LFP 17 - 37	22 / 30	367	343	314	279	240	2508	3320	145	143	52
LFP 17 - 38	22 / 30	376	351	321	286	245	2568	3381	145	143	53
LFP 17 - 39	22 / 30	385	360	328	292	250	2629	3441	145	143	54
LFP 17 - 40	22 / 30	394	368	336	298	255	2689	3501	145	143	55
LFP 17 - 43	26 / 35	428	400	366	326	280	3118	3992	145	143	59
LFP 17 - 45	26 / 35	446	417	381	339	291	3239	4113	145	143	62
LFP 17 - 48	26 / 35	473	441	403	358	306	3420	4294	145	143	65
LFP 17 - 51	30 / 40	502	468	428	380	325	3602	4546	145	143	69
LFP 17 - 53	30 / 40	522	486	445	395	338	3723	4667	145	143	71
LFP 17 - 55	30 / 40	542	505	462	410	351	3844	4788	145	143	74
LFP 17 - 51	30 / 40	502	468	428	380	325	3602	4742	145	143	69
LFP 17 - 53	30 / 40	522	486	445	395	338	3723	4863	145	143	71
LFP 17 - 55	30 / 40	542	505	462	410	351	3844	4984	188	188	74
LFP 17 - 58	37 / 50	571	533	487	433	370	4025	5165	188	188	78
LFP 17 - 60	37 / 50	591	551	504	447	382	4146	5286	188	188	80

* Motor type / size may change as per requirement.

** Maximum diameter of pump with two cable guard.



Performance Curve

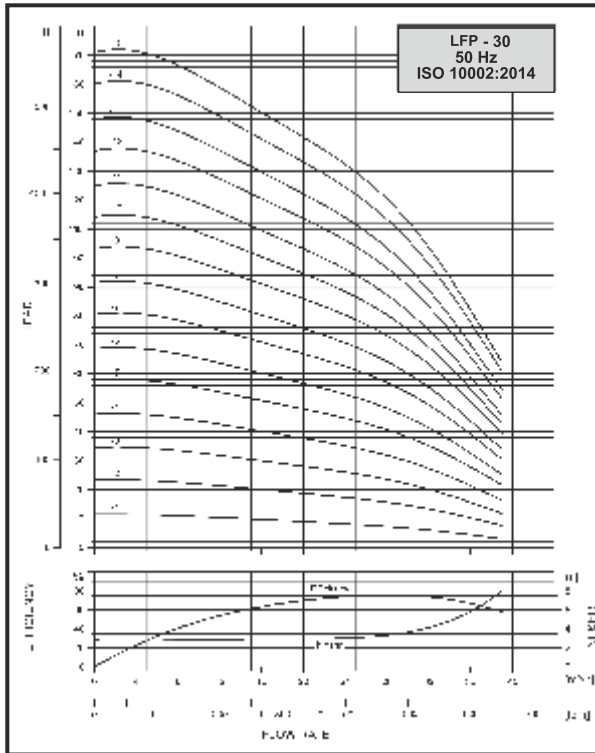

Performance Curve

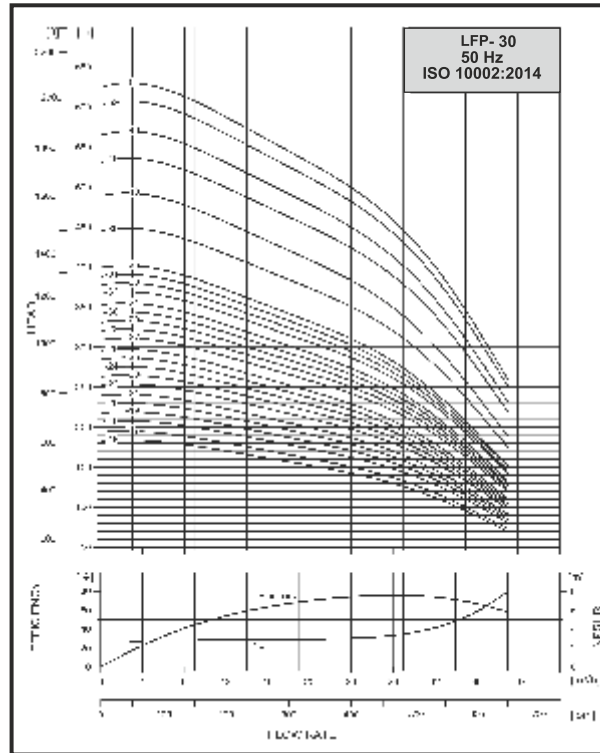

Power Curve

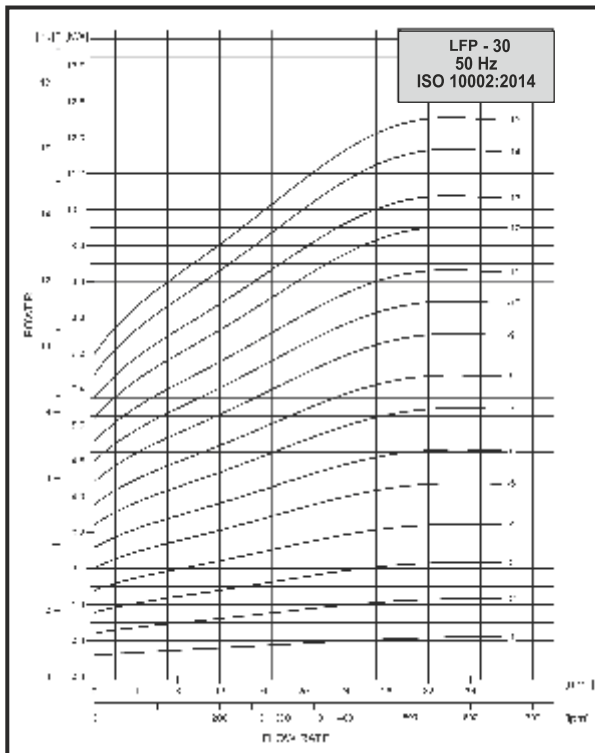

Power Curve

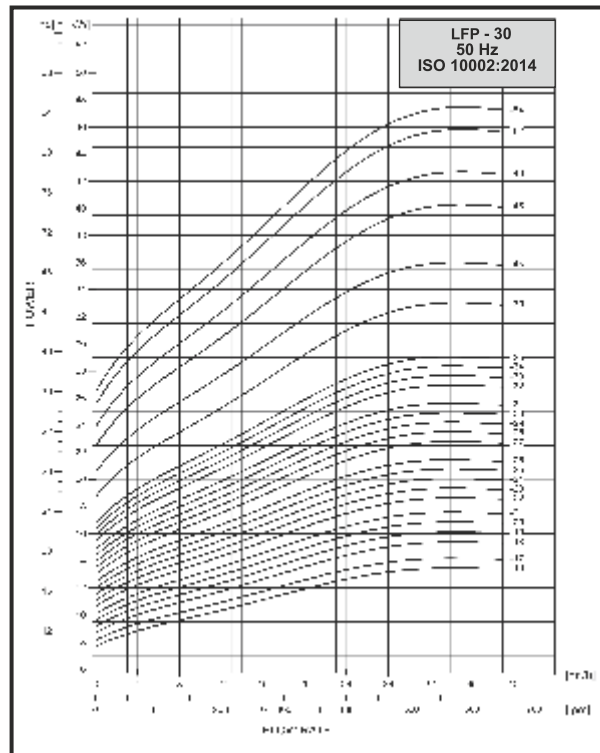

Dimensions, Weights and Performance Table

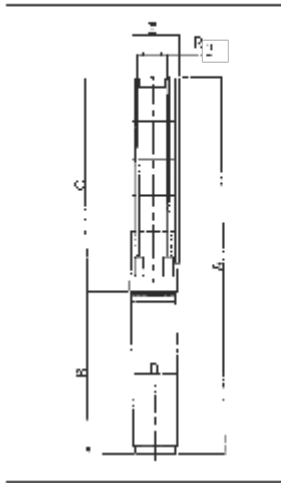

LFP 30 39 to LFP 30 54 are mounted in S.S. Pipe sleeve.

Model - Stage	m ³ / hrs Ltr / Min.	Discharges (Q)					Dimensions in (mm)				Pump Net Weight In Kgs
		20	24	28	32	39	3/4" Thread Connection				
	Motor kw / HP	Total Head in Meters					C	A	D*	E**	
LFP 30 1	1.1 / 1.5	9	8	7	6	3	349	658	95	131	8
LFP 30 2	2.2 / 3	19	17	16	13	8	445	902	95	131	10
LFP 30 3	3 / 4.0	28	26	24	20	12	541	1037	95	131	12
LFP 30 4	4 / 5.5	38	35	32	27	16	637	1213	95	131	14
LFP 30 5	5.5 / 7.5	48	45	41	35	22	733	1409	95	131	16
LFP 30 6	5.5 / 7.5	57	53	48	41	25	829	1505	95	131	18
LFP 30 7	7.5 / 10	67	63	57	49	31	925	1702	95	131	20
LFP 30 8	7.5 / 10	76	71	64	55	34	1021	1798	95	131	22
LFP 30 5	5.5 / 7.5	48	45	41	35	27	749	1797	145	145	16
LFP 30 6	5.5 / 7.5	57	53	48	41	25	845	1388	145	145	18
LFP 30 7	7.5 / 10	67	63	57	49	31	941	1515	145	145	20
LFP 30 8	7.5 / 10	76	71	64	55	34	1037	1611	145	145	22
LFP 30 9	9.2 / 12.5	86	80	73	63	39	1133	1737	145	145	24
LFP 30 10	9.2 / 12.5	95	88	80	69	43	1229	1833	145	145	25
LFP 30 11	9.2 / 12.5	103	96	87	75	46	1325	1929	145	145	27
LFP 30 12	11 / 15	114	106	97	83	51	1421	2056	145	145	29
LFP 30 13	11 / 15	122	114	103	89	55	1517	2152	145	145	31
LFP 30 14	13 / 17.5	133	125	113	98	61	1613	2277	145	145	33
LFP 30 15	13 / 17.5	142	132	120	104	64	1709	2373	145	145	35
LFP 30 16	15 / 20	153	143	130	112	70	1805	2503	145	145	37
LFP 30 17	15 / 20	161	151	137	118	74	1901	2599	145	145	39
LFP 30 18	18.5 / 25	173	163	148	129	82	1997	2751	145	145	41
LFP 30 19	18.5 / 25	182	171	156	135	85	2093	2847	145	145	42
LFP 30 20	18.5 / 25	191	179	163	141	89	2189	2943	145	145	44
LFP 30 21	18.5 / 25	200	187	170	147	92	2285	3039	145	145	46
LFP 30 22	22 / 30	211	198	180	156	99	2381	3193	145	145	48
LFP 30 23	22 / 30	220	206	188	162	102	2477	3289	145	145	50
LFP 30 24	22 / 30	228	214	195	168	105	2573	3385	145	145	52
LFP 30 25	22 / 30	237	221	201	174	108	2669	3481	145	145	54
LFP 30 26	22 / 30	245	229	208	179	111	2765	3577	145	145	56
LFP 30 27	26 / 35	259	242	221	191	121	2861	3735	145	145	58
LFP 30 28	26 / 35	267	250	228	197	124	2957	3831	145	145	59
LFP 30 29	26 / 35	276	258	235	203	127	3053	3927	145	145	61
LFP 30 30	26 / 35	284	266	242	209	130	3149	4023	145	145	63
LFP 30 31	30 / 40	293	274	249	215	133	3245	4189	145	145	65
LFP 30 32	30 / 40	306	287	262	227	143	3341	4285	145	145	67
LFP 30 33	30 / 40	315	295	269	232	146	3437	4381	145	145	69
LFP 30 34	30 / 40	324	303	276	238	149	3533	4477	145	145	71
LFP 30 35	30 / 40	332	310	283	244	152	3629	4573	145	145	73
LFP 30 31	30 / 40	293	274	249	215	133	3745	4385	188	188	65
LFP 30 32	30 / 40	306	287	262	227	143	3841	4481	188	188	67
LFP 30 33	30 / 40	315	295	269	232	146	3937	4577	188	188	69
LFP 30 34	30 / 40	324	303	276	238	149	4033	4673	188	188	71
LFP 30 35	30 / 40	332	310	283	244	152	4129	4769	188	188	73
LFP 30 39	37 / 50	374	351	320	278	176	4260	5400	188	188	80
LFP 30 43	37 / 50	409	383	350	303	190	4544	5784	188	188	88
LFP 30 46	45 / 60	451	424	389	341	220	4881	6111	188	188	93
LFP 30 49	45 / 60	478	450	413	361	233	5169	6399	188	188	99
LFP 30 52	55 / 75	-	-	-	-	-	5457	6707	188	188	105
LFP 30 54	55 / 75	-	-	-	-	-	5649	6989	188	188	109

* Motor type / size may change as per requirement.

** Maximum diameter of pump with two cable gland.



Performance Curve

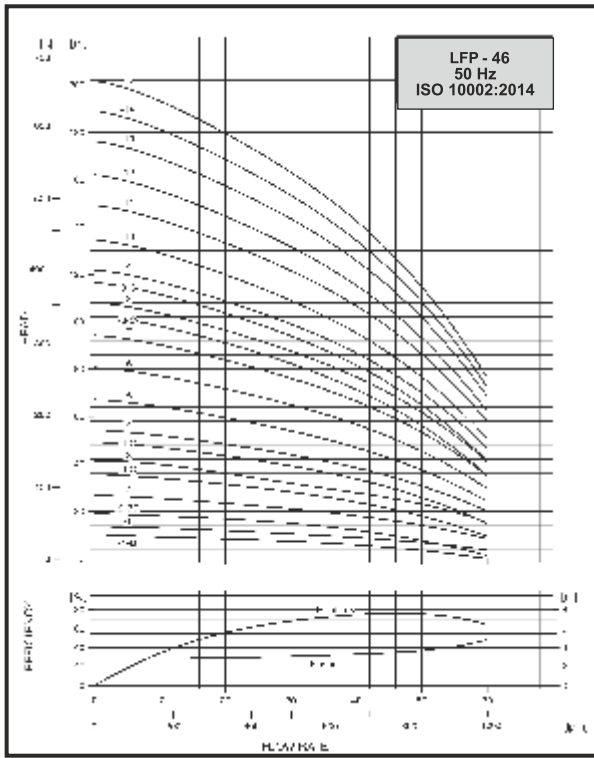

Performance Curve

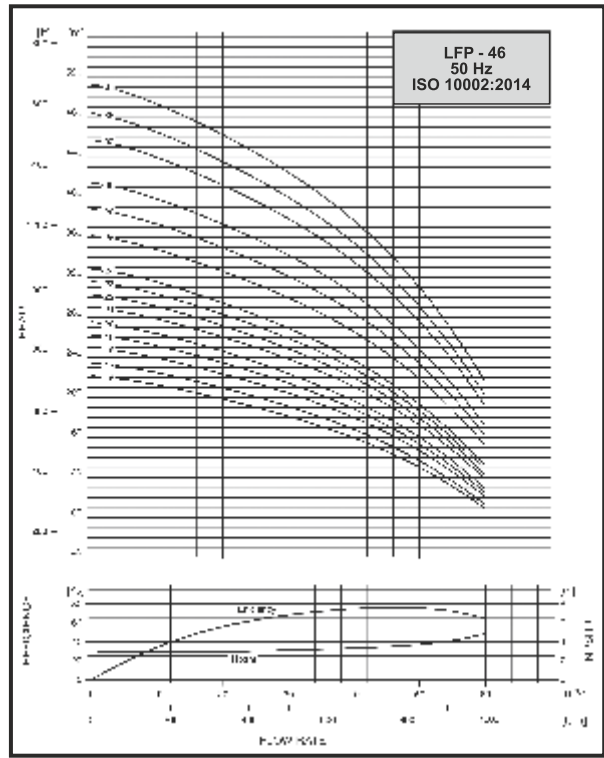

Power Curve

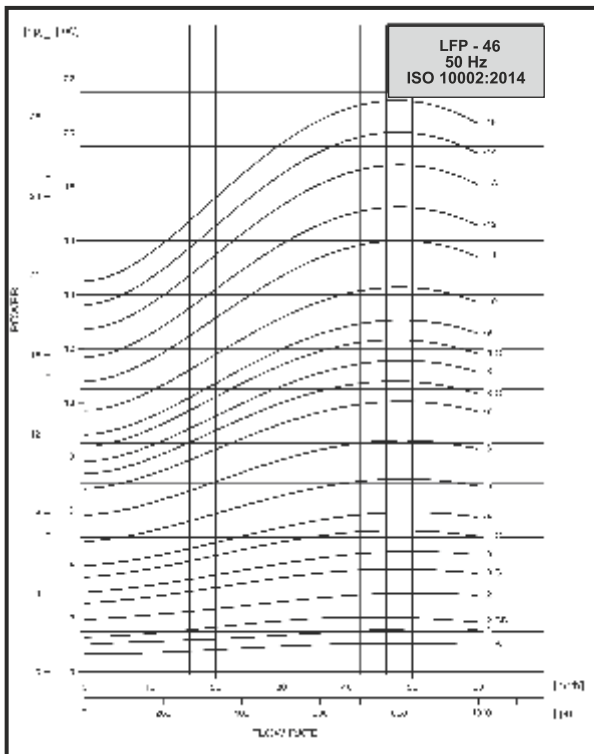

Power Curve

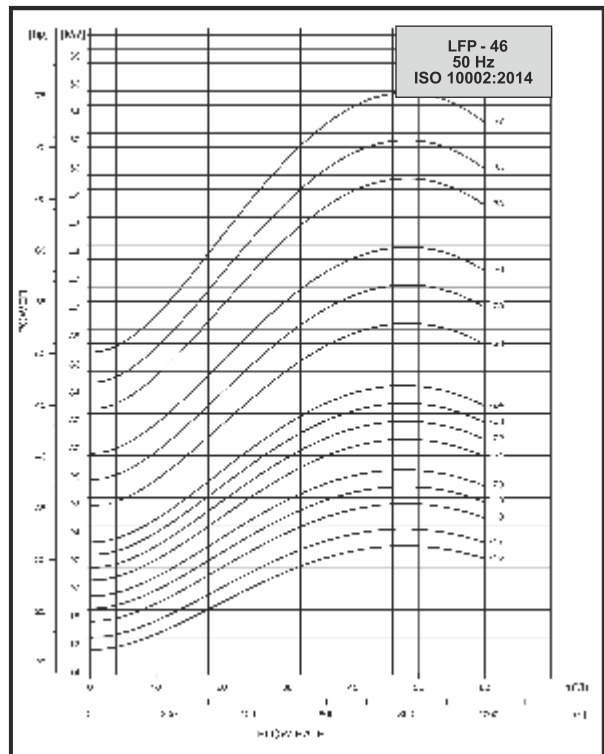

Dimensions, Weights and Performance Table

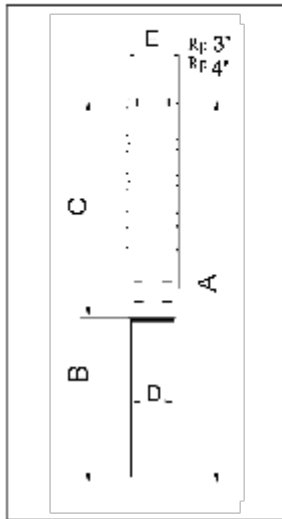

LFP 46 26 to LFP 46 37 are mounted in s.s. pipe sleeve.

Model - Stage	m ³ / hrs Ltr / Min. Motor kw / HP	Discharges (Q)					Dimensions in (mm)				Pump Net Weight In Kgs
		35	40	45	50	55	Rp 4" Thread Connection				
		583	667	750	833	917	Total Head in Meters				
		C	A	D*	E**						
LFP 46 - 1-R	1.1 / 1.5	-	-	-	-	-	370	679	95	145	6
LFP 46 - 1	2.2 / 3.0	-	-	-	-	-	370	718	95	145	6
LFP 46 - 2-BB	2.2 / 3.0	14	12	10	8	5	483	831	95	145	8
LFP 46 - 2	3 / 4.0	20	18	16	14	11	483	979	95	145	8
LFP 46 - 3-C	4 / 5.5	26	24	21	18	14	596	1170	95	145	11
LFP 46 - 3	5.5 / 7.5	30	28	26	23	20	596	1271	95	145	11
LFP 46 - 4-C	5.5 / 7.5	37	34	30	26	21	709	1366	95	145	13
LFP 46 - 4	7.5 / 10	41	38	35	31	26	709	1486	95	145	13
LFP 46 - 3	5.5 / 7.5	30	28	26	23	20	517	1156	145	152	17
LFP 46 - 4-C	5.5 / 7.5	37	34	30	26	21	709	1253	145	152	14
LFP 46 - 4	7.5 / 10	41	38	35	31	26	725	1299	145	152	14
LFP 46 - 5	7.5 / 10	51	47	43	37	31	838	1412	145	152	16
LFP 46 - 6	9.2 / 12.5	61	57	51	45	38	951	1555	145	152	18
LFP 46 - 7	11 / 15	72	66	60	53	45	1064	1698	145	152	20
LFP 46 - 8-C	11 / 15	77	71	64	56	46	1177	1811	145	152	22
LFP 46 - 8	13 / 17.5	83	77	70	62	52	1177	1841	145	152	22
LFP 46 - 9-C	13 / 17.5	88	82	74	65	54	1290	1954	145	152	24
LFP 46 - 9	15 / 20	93	87	79	70	59	1290	1988	145	152	24
LFP 46 - 10	15 / 20	103	95	87	77	65	1403	2101	145	152	27
LFP 46 - 11	18.5 / 25	115	107	97	86	73	1516	2270	145	152	29
LFP 46 - 12	18.5 / 25	124	115	105	93	79	1629	2383	145	152	31
LFP 46 - 13	22 / 30	135	126	115	102	86	1855	2667	145	152	34
LFP 46 - 14	22 / 30	144	134	122	108	92	1855	2667	145	152	35
LFP 46 - 15	22 / 30	154	143	130	115	97	1968	2780	145	152	38
LFP 46 - 16	26 / 35	166	155	141	125	106	2081	2955	145	152	41
LFP 46 - 17	26 / 35	175	163	149	132	117	2194	3068	145	152	43
LFP 46 - 18	30 / 40	188	175	160	142	121	2307	3251	145	152	45
LFP 46 - 19	30 / 40	197	183	167	148	126	2420	3364	145	152	47
LFP 46 - 20	30 / 40	206	192	175	155	132	2513	3557	145	152	50
LFP 46 - 18	30 / 40	188	175	160	142	121	2307	3447	145	152	47
LFP 46 - 19	30 / 40	197	183	167	148	126	2420	3580	145	152	49
LFP 46 - 20	30 / 40	206	192	175	155	132	2513	3753	145	152	52
LFP 46 - 21	37 / 50	221	206	188	167	143	2726	3866	188	188	54
LFP 46 - 22	37 / 50	230	215	196	174	148	2839	3979	188	188	56
LFP 46 - 23	37 / 50	240	223	204	181	154	2952	4092	188	188	57
LFP 46 - 24	37 / 50	249	232	212	188	160	3065	4205	188	188	59
LFP 46 - 26	45 / 60	279	261	239	214	183	3403	4633	188	188	64
LFP 46 - 28	45 / 60	299	280	256	229	196	3629	4859	188	188	68
LFP 46 - 30	45 / 60	319	298	273	244	208	3855	5085	188	188	73
LFP 46 - 33	55 / 75	354	331	303	271	232	4194	538	188	188	80
LFP 46 - 35	55 / 75	-	-	-	-	-	4420	5760	188	188	84
LFP 46 - 37	55 / 75	-	-	-	-	-	4646	5986	188	188	89

* Motor type / size may change as per requirement.

** Maximum diameter of pump with two cable guard.



Performance Curve

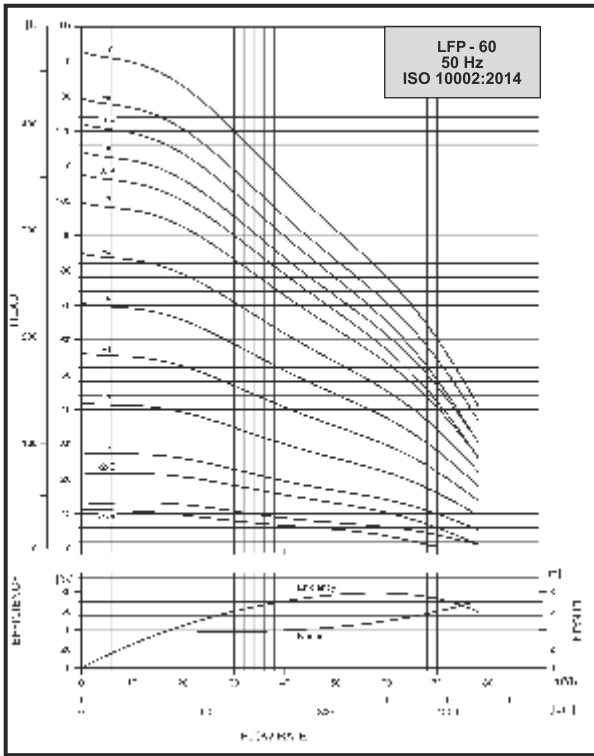

Performance Curve

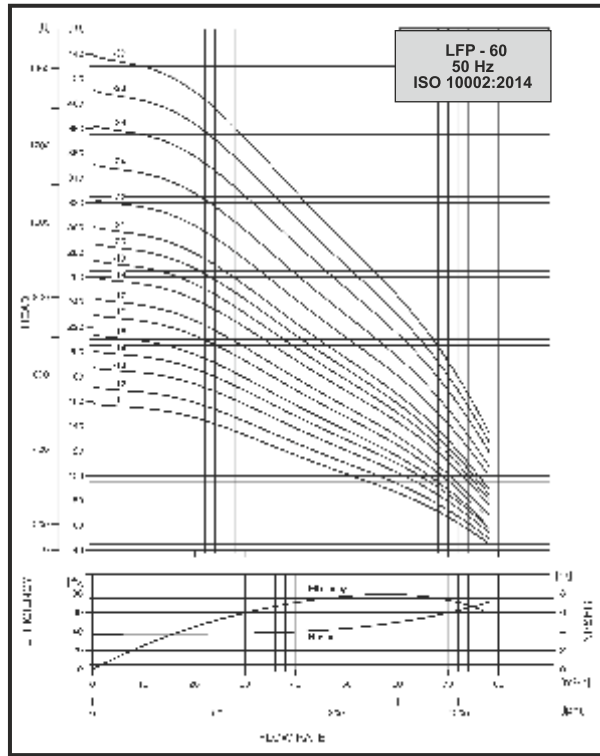

Power Curve

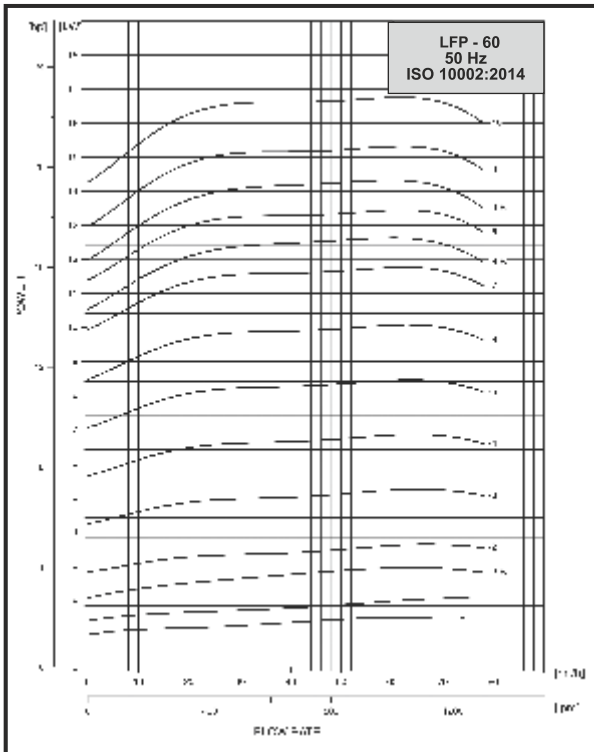

Power Curve

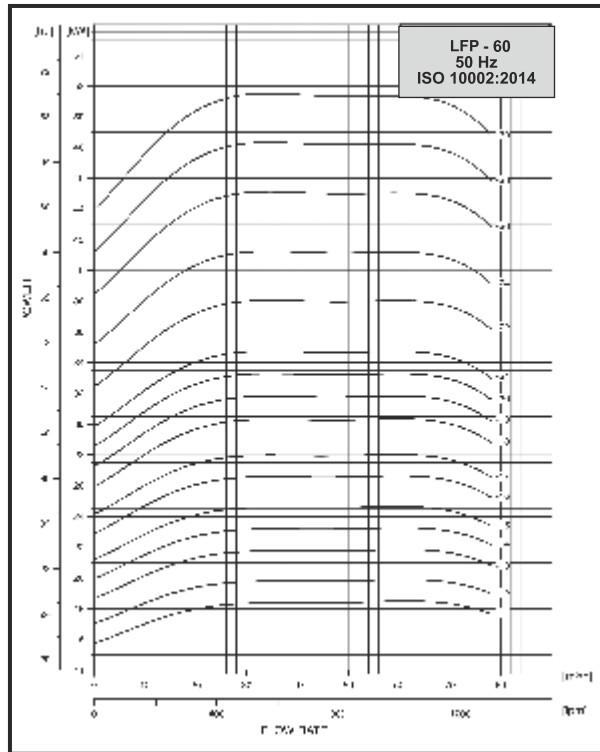

Dimensions, Weights and Performance Table

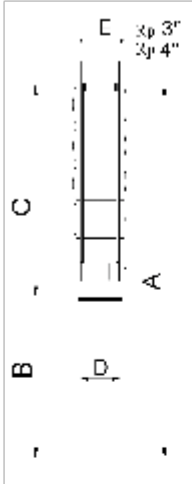

Model - Stage	m ³ / hrs ltr / Min. Motor kw / HP	Discharges (Q)					Dimensions in (mm)				Pump Net Weight In Kgs
		40	50	60	70	78	Rø 4" Thread Connection				
		667	833	1000	1167	1300	Total Head in Meters				
						C	A	D*	E**		
LFP 60 1-A	1.5 / 2	-	-	-	-	-	370	865	95	145	6
LFP 60 1	2.2 / 3	-	-	-	-	-	370	946	95	145	6
LFP 60 2-B	3.0 / 4	15	13	10	6	1	483	977	95	145	8
LFP 60 2	4 / 5.5	19	17	14	10	5	483	1059	95	145	8
LFP 60 3	5.5 / 7.5	30	26	22	16	10	596	1271	95	145	10
LFP 60 4	7.5 / 10	41	35	30	22	14	709	1486	95	145	12
LFP 60 3	5.5 / 7.5	30	26	22	16	10	596	1139	145	152	11
LFP 60 4	7.5 / 10	41	35	30	22	14	709	1283	145	152	13
LFP 60 5	9.2 / 12.5	51	44	38	28	18	838	1447	145	152	15
LFP 60 6	11 / 15	62	54	45	34	22	951	1586	145	152	17
LFP 60 7	13 / 17.5	73	63	53	40	26	1064	1728	145	152	20
LFP 60 8-B	13 / 17.5	79	68	57	42	26	1177	1841	145	152	22
LFP 60 8	15 / 20	84	73	61	47	31	1177	1875	145	152	22
LFP 60 9-B	15 / 20	90	78	65	48	30	1290	1988	145	152	24
LFP 60 9	18.5 / 25	95	83	71	54	37	1290	2044	145	152	24
LFP 60 10	18.5 / 25	105	92	78	60	41	1403	2157	145	152	27
LFP 60 11	22 / 30	116	101	86	67	45	1516	2328	145	152	29
LFP 60 12	22 / 30	126	110	94	72	50	1629	2441	145	152	31
LFP 60 13	26 / 30	138	120	103	79	54	1742	2616	145	152	33
LFP 60 14	26 / 30	148	129	110	85	58	1855	2729	145	152	35
LFP 60 15	26 / 30	157	136	116	89	60	1968	2842	145	152	38
LFP 60 16	30 / 40	169	147	125	96	65	2081	3025	145	152	40
LFP 60 17	30 / 40	179	155	132	101	69	2194	3138	145	152	42
LFP 60 16	30 / 40	169	147	125	96	65	2081	3025	188	188	42
LFP 60 17	30 / 40	179	155	132	101	69	2194	3138	188	188	44
LFP 60 18	37 / 50	193	168	143	111	77	2387	3527	188	188	46
LFP 60 19	37 / 50	203	177	151	117	81	2500	3640	188	188	48
LFP 60 20	37 / 50	213	186	158	123	85	2613	3753	188	188	50
LFP 60 21	37 / 50	223	194	166	129	89	2726	3866	188	188	52
LFP 60 22	45 / 60	242	211	181	142	100	2788	4018	188	188	54
LFP 60 24	45 / 60	-	-	-	-	-	3177	4407	188	188	58
LFP 60 26	55 / 75	-	-	-	-	-	3403	4743	188	188	62
LFP 60 28	55 / 75	-	-	-	-	-	3629	4969	188	188	67
LFP 60 30	55 / 75	-	-	-	-	-	3855	5195	188	188	71

* Motor type / size may change as per requirement.

** Maximum diameter of pump with two cable guard.



Performance Curve

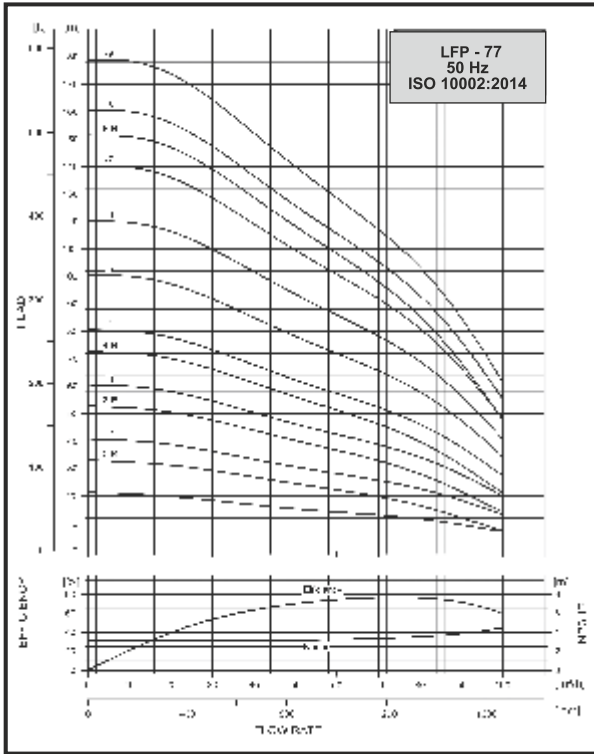

Performance Curve

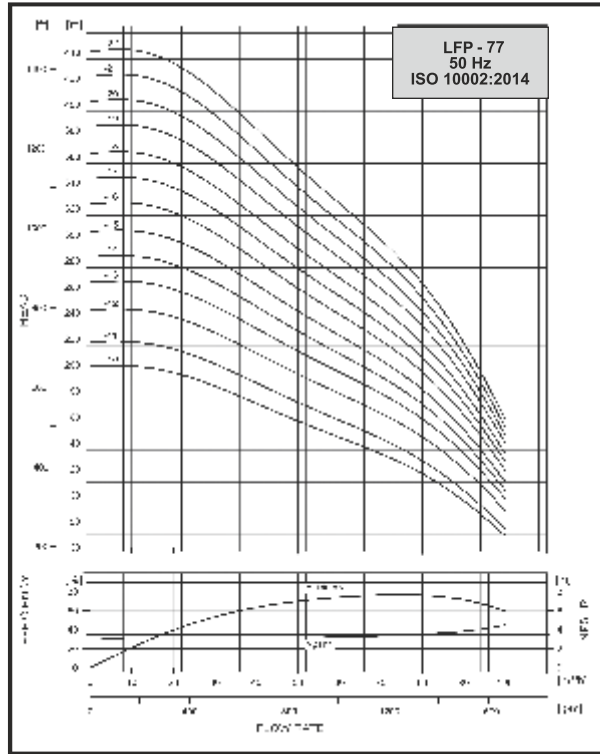

Power Curve

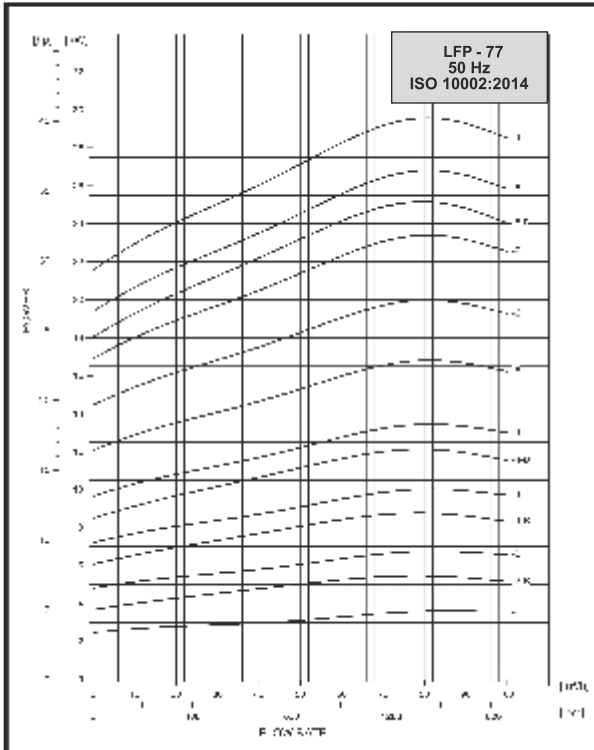

Power Curve

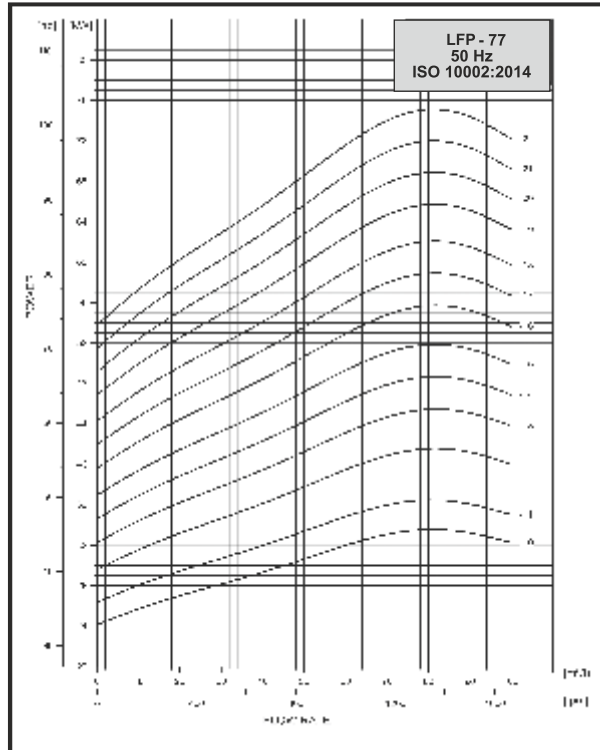

Dimensions, Weights and Performance Table

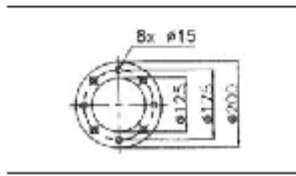
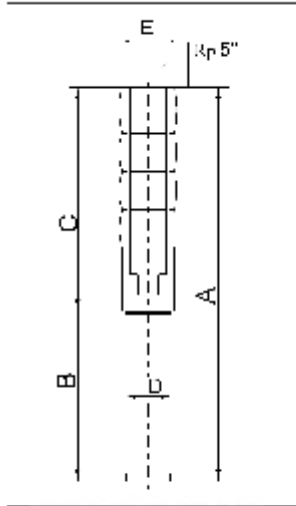

Model - Stage	m ³ / hrs ltr / Min. Motor kw / HP	Discharges (Q)					Dimensions in (mm)				Pump Net Weight In Kgs
		50	60	70	80	90	Rø 5" Thread Connection				
		833	1000	1167	1333	1500	Total Head in Meters				
		C	A	D*	E**						
LFP 77 - 1	5.5 / 7.5	15	14	13	12	10	618	1161	145	186	21
LFP 77 - 2-B	5.5 / 7.5	25	22	20	16	12	746	1289	145	186	24
LFP 77 - 2	7.5 / 10	31	28	26	23	18	746	1320	145	186	24
LFP 77 - 3-B	9.2 / 12.5	40	37	33	28	22	874	1478	145	186	28
LFP 77 - 3	11 / 15	46	42	39	34	28	874	1508	145	186	28
LFP 77 - 4-B	13 / 17.5	56	51	46	40	31	1003	1667	145	186	31
LFP 77 - 4	15 / 20	62	57	52	46	38	1003	1701	145	186	31
LFP 77 - 5	18.5 / 25	78	72	66	58	47	1131	1885	145	186	35
LFP 77 - 6	22 / 30	94	86	78	69	56	1259	2071	145	186	38
LFP 77 - 7	26 / 35	110	101	92	81	66	1387	2261	145	186	42
LFP 77 - 8-B	26 / 35	118	108	98	85	68	1515	2389	145	186	46
LFP 77 - 8	30 / 40	126	116	105	93	76	1515	2459	145	186	46
LFP 77 - 9	30 / 40	140	129	117	103	85	1643	2587	145	186	49
LFP 77 - 8	30 / 40	176	116	105	93	76	1515	2655	188	186	46
LFP 77 - 9	30 / 40	140	129	117	103	85	1643	2783	188	186	49
LFP 77 - 10	37 / 50	157	145	132	117	96	1771	2911	188	186	53
LFP 77 - 11	37 / 50	172	158	144	127	104	1914	3054	188	186	57
LFP 77 - 12	45 / 60	193	178	163	145	120	2043	3273	188	186	60
LFP 77 - 13	55 / 75	211	195	178	159	132	2172	3512	188	186	64
LFP 77 - 14	55 / 75	226	209	191	170	141	2300	3640	188	186	68
LFP 77 - 15	55 / 75	242	223	204	181	150	2429	3769	188	186	71
LFP 77 - 16	63 / 85	259	239	219	195	162	2557	4047	188	186	75
LFP 77 - 17	63 / 85	274	253	232	206	171	2685	4175	188	186	78
LFP 77 - 18	63 / 85	290	267	244	217	180	2814	4304	188	186	82
LFP 77 - 19	75 / 100	307	283	259	230	191	3236	4796	188	186	85
LFP 77 - 20	75 / 100	322	297	271	241	200	3364	4924	188	186	89
LFP 77 - 21	75 / 100	-	-	-	-	-	3492	5052	188	186	93
LFP 77 - 22	93 / 125	-	-	-	-	-	3620	5360	188	186	96

* Motor type / size may change as per requirement.

** Maximum diameter of pump with twin cable guard.



Performance Curve

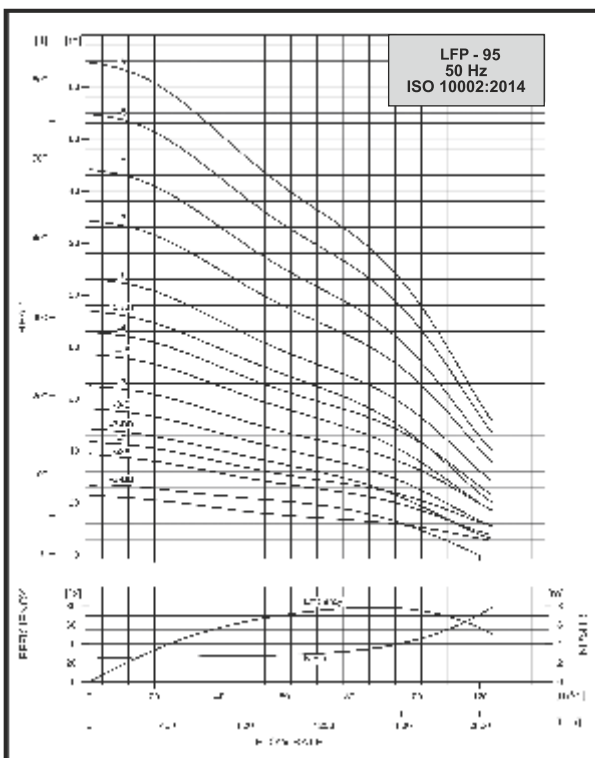

Performance Curve

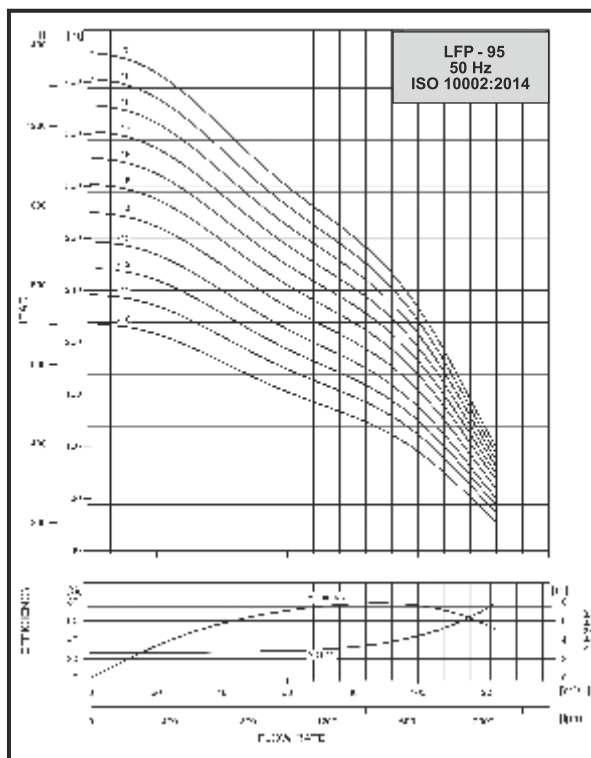

Power Curve

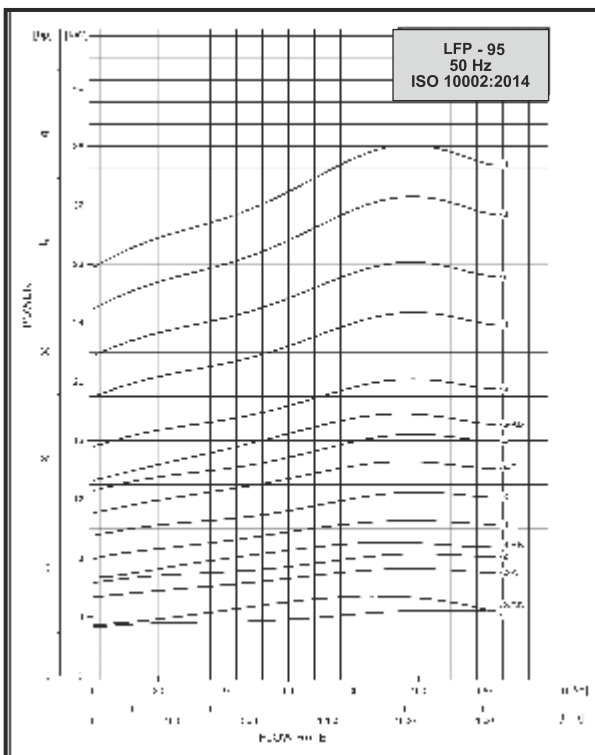

Power Curve

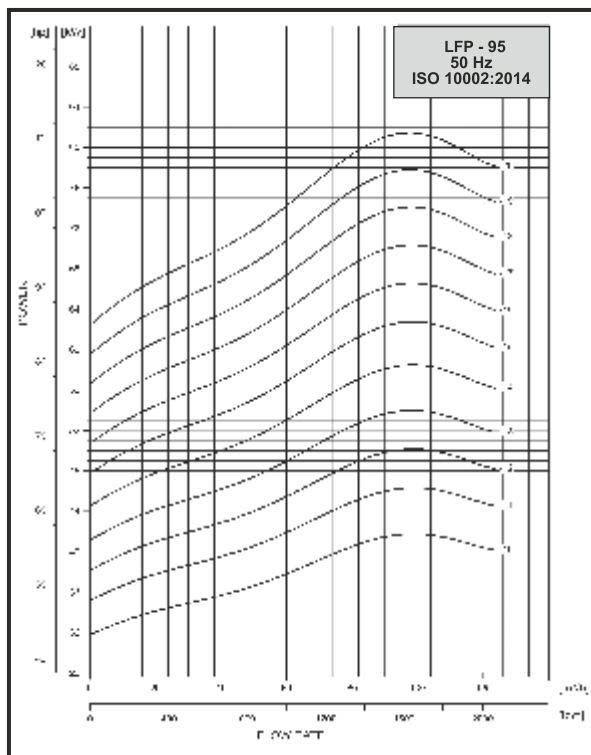

Dimensions, Weights and Performance Table

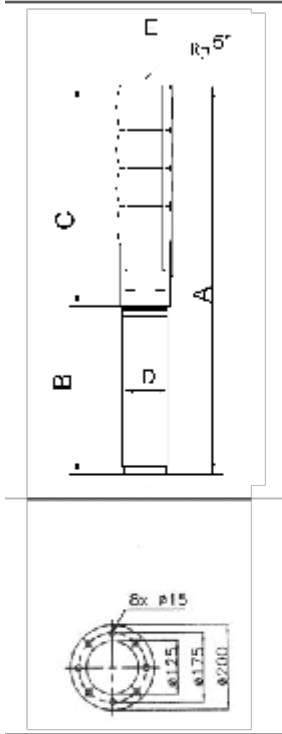

Model - Stage	m ³ / hrs Ltr / Min. Motor kw / HP	Discharges (Q)					Dimensions in (mm)				Pump Net Weight: In Kgs
		80	90	100	110	120	Rp 5" Thread Connection				
		1333	1500	1667	1833	2000	C	A	D*	E**	
		Total Head in Meters									
LFP 95 - 1	5.5 / 7.5	13	12	11	9	6	618	1161	145	186	21
LFP 95 - 2BB	5.5 / 7.5	17	14	10	6	2	746	1289	145	186	24
LFP 95 - 2-A	7.5 / 10	24	21	18	14	9	746	1320	145	186	24
LFP 95 - 2	9.2 / 12.5	27	25	22	17	13	746	1350	145	186	24
LFP 95 - 3BB	9.2 / 12.5	29	25	20	16	8	874	1478	145	186	28
LFP 95 - 3-B	11 / 15	35	31	26	20	13	874	1508	145	186	28
LFP 95 - 3	13 / 17.5	42	38	33	27	20	874	1538	145	186	28
LFP 95 - 4-B	15 / 20	49	44	37	29	20	1003	1701	145	186	31
LFP 95 - 4	18.5 / 25	55	51	44	36	26	1003	1757	145	186	31
LFP 95 - 5A3	18.5 / 25	60	54	45	35	24	1131	1885	145	186	35
LFP 95 - 5	22 / 30	69	63	55	44	32	1131	1943	145	186	35
LFP 95 - 6	26 / 35	84	77	68	55	41	1259	2133	145	186	38
LFP 95 - 7	30 / 40	96	88	77	62	46	1387	2331	145	186	42
LFP 95 - 7	30 / 40	96	88	77	62	46	1387	2327	188	186	42
LFP 95 - 8	37 / 50	112	102	90	73	54	1515	2655	188	186	46
LFP 95 - 9	45 / 60	124	114	99	80	59	1642	2872	188	186	49
LFP 95 - 10	45 / 60	143	132	116	95	71	1785	3015	188	186	53
LFP 95 - 11	55 / 75	158	146	129	106	79	1914	3254	188	186	56
LFP 95 - 12	55 / 75	172	158	140	115	86	2043	3383	188	186	60
LFP 95 - 13	55 / 75	185	170	150	123	92	2172	3512	188	186	63
LFP 95 - 14	63 / 85	201	185	163	134	100	2300	3770	188	186	67
LFP 95 - 15	75 / 100	215	198	175	144	107	2429	3989	188	186	71
LFP 95 - 16	75 / 100	229	211	186	152	114	2557	4117	188	186	74
LFP 95 - 17	75 / 100	242	223	196	160	120	2685	4245	188	186	78
LFP 95 - 18	93 / 125	255	235	206	169	125	3108	4848	188	186	81
LFP 95 - 19	93 / 125	269	247	216	177	131	3236	4976	188	186	85
LFP 95 - 20	93 / 125	281	258	226	184	137	3364	5104	188	186	88

* Motor type / size may change as per requirement.

** Maximum diameter of pump with two cable guard.



Performance Curve

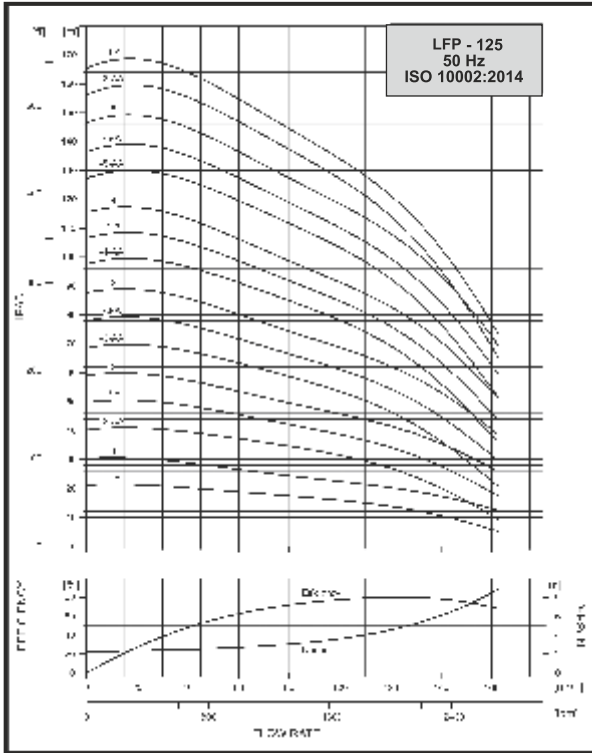

Performance Curve

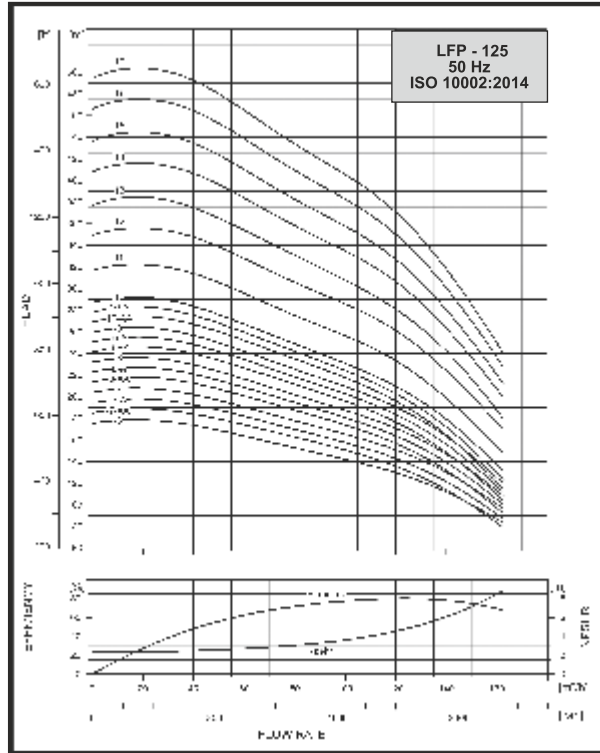

Power Curve

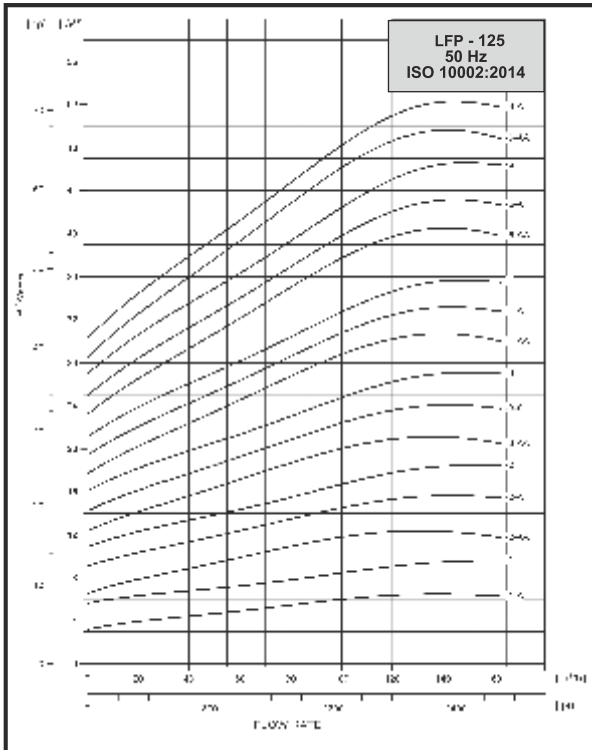

Power Curve

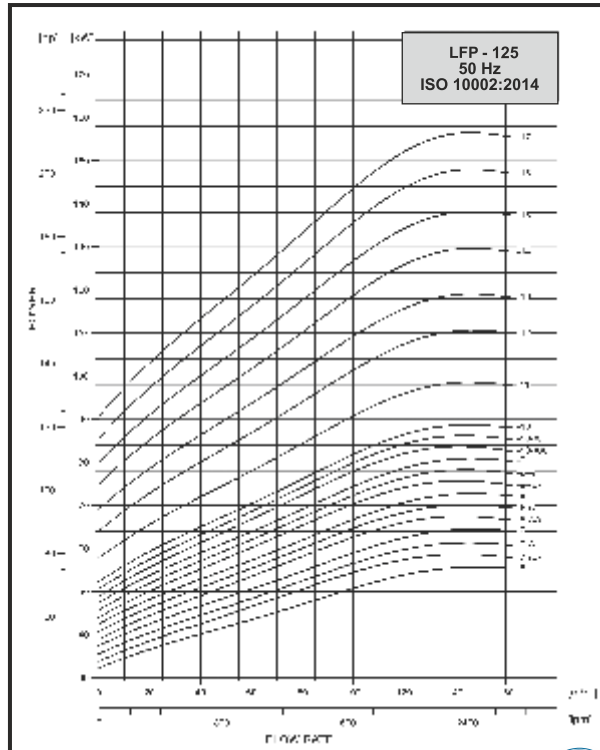

Dimensions, Weights and Performance Table

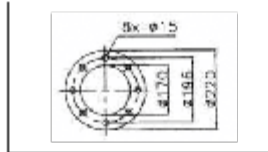
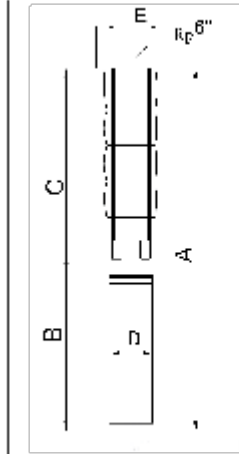

Model - Stage	m ³ /h* Ltr / Min.	Discharges (Q)					Dimensions in (mm)				Pump Net Weight In Kgs
		110	120	130	140	150	Rp 6" Thread Connection				
		1833	2000	2167	2333	2500	C	A	D*	E**	
Motor kw / HP	Total Head in Meters										
LFP 125 - 1-A	7.5 / 10	15	14	12	10	8	651	1225	145	218	27
LFP 125 - 1	11 / 15	21	20	19	17	15	651	1286	145	218	27
LFP 125 - 2AA	13 / 17.5	29	27	24	20	16	807	1471	145	218	33
LFP 125 - 2-A	18.5 / 25	37	34	31	28	23	807	1561	145	218	33
LFP 125 - 2	22 / 30	44	42	39	35	32	807	1619	145	218	33
LFP 125 - 3AA	22 / 30	50	47	42	36	30	963	1775	145	218	39
LFP 125 - 3-A	26 / 35	58	54	50	45	38	963	1837	145	218	39
LFP 125 - 3	30 / 40	66	62	58	53	47	963	1907	145	218	39
LFP 125 - 4AA	37 / 50	74	69	63	56	48	1119	2259	188	218	45
LFP 125 - 4-A	37 / 50	81	76	70	63	55	1119	2259	188	218	45
LFP 125 - 4	37 / 50	87	83	77	71	63	1119	2259	188	218	45
LFP 125 - 5AA	45 / 60	98	93	85	77	66	1275	2505	188	218	51
LFP 125 - 5-A	45 / 60	105	100	93	84	74	1275	2505	188	218	51
LFP 125 - 5	55 / 75	114	108	102	93	84	1275	2615	188	218	51
LFP 125 - 6AA	55 / 75	121	114	106	95	83	1431	2771	188	218	57
LFP 125 - 6-A	55 / 75	128	121	113	103	91	1431	2771	188	218	57
LFP 125 - 6	63 / 85	135	130	122	112	100	1431	2901	188	218	57
LFP 125 - 7AA	63 / 85	144	136	126	114	100	1587	3057	188	218	63
LFP 125 - 7-A	63 / 85	151	143	133	122	107	1587	3057	188	218	63
LFP 125 - 7	75 / 100	159	151	142	130	117	1587	3147	188	218	63
LFP 125 - 8AA	75 / 100	168	157	146	132	116	1743	3303	188	218	70
LFP 125 - 8-A	75 / 100	173	164	153	139	123	1743	3303	188	218	70
LFP 125 - 8	75 / 100	180	171	160	147	131	1743	3303	188	218	70
LFP 125 - 9AA	93 / 125	187	177	164	149	130	1899	3639	188	218	76
LFP 125 - 9-A	93 / 125	194	184	171	156	138	1899	3639	188	218	76
LFP 125 - 9	93 / 125	201	191	178	163	146	1899	3639	188	218	76
LFP 125 - 10AA	93 / 125	208	196	182	165	144	2055	3795	188	218	82
LFP 125 - 10-A	93 / 125	214	203	189	172	152	2055	3795	188	218	82
LFP 125 - 10	93 / 125	221	210	196	179	159	2055	3795	188	218	82
LFP 125 - 11	110 / 150	-	-	-	-	-	2507	4567	237	227	91
LFP 125 - 12	132 / 175	-	-	-	-	-	2714	4584	237	227	97
LFP 125 - 13	132 / 175	-	-	-	-	-	2870	4740	237	227	104
LFP 125 - 14	147 / 200	-	-	-	-	-	3025	4815	237	227	110
LFP 125 - 15	147 / 200	-	-	-	-	-	3181	4971	237	227	116
LFP 125 - 16	185 / 250	-	-	-	-	-	3336	5216	237	227	122
LFP 125 - 17	185 / 250	-	-	-	-	-	3492	5372	237	227	128

* Motor type / size may change as per requirement.

** Maximum diameter of pump with two cable g.c.crc.



Performance Curve

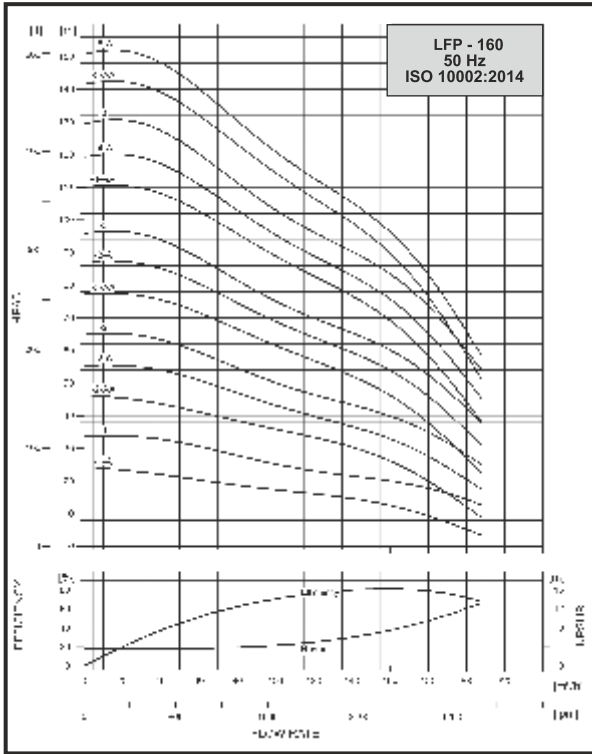

Performance Curve

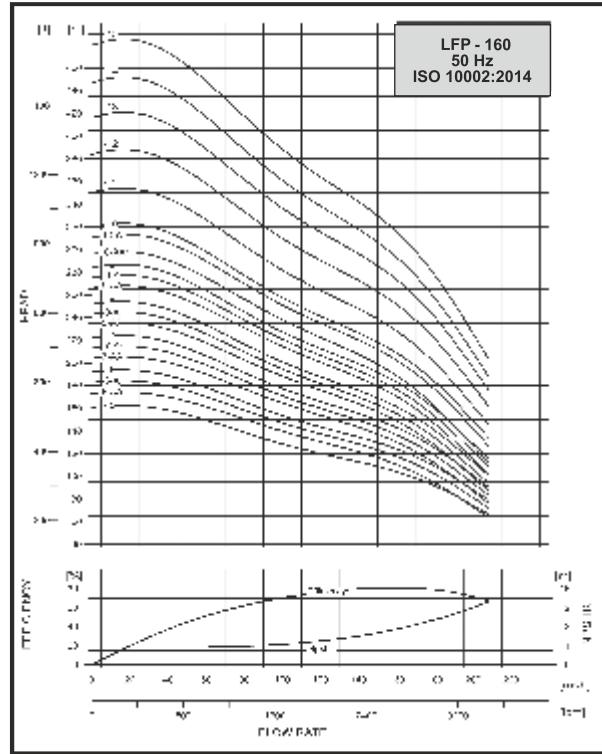

Power Curve

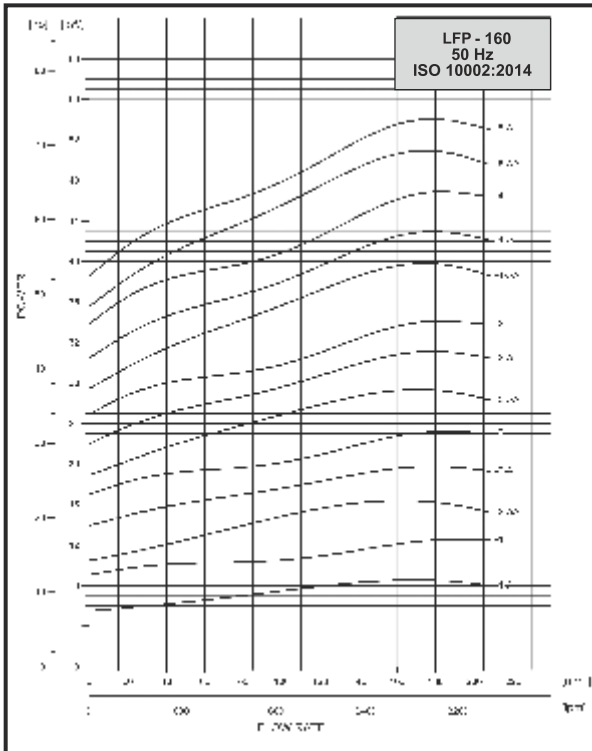

Power Curve

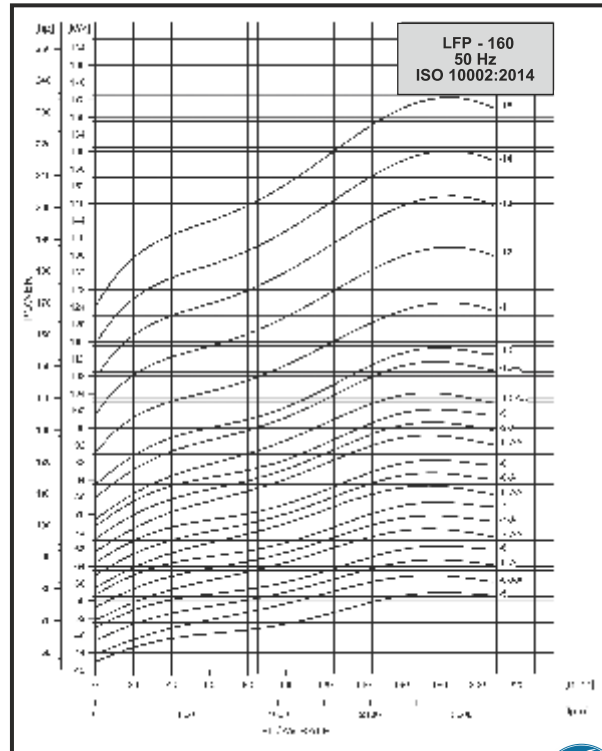

Dimensions, Weights and Performance Table

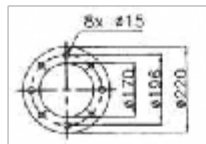
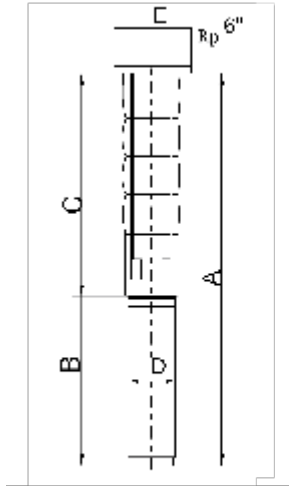

Model - Stage	m ³ / hrs Ltr / Min.	Discharges (Q)					Dimensions in (mm)				Pump Net Weight In Kgs
		150	160	170	180	190	Rp 6" Thread Connection				
	2500	2667	2833	3000	3167	Total Head in Meters		C	A	D*	
LFP 160 - 1-A	7.5 / 10	14	13	11	9	7	651	1371	143	218	26
LFP 160 - 1	13 / 17.5	21	20	19	18	16	651	1315	145	218	26
LFP 160 - 2AA	18.5 / 25	29	26	23	20	16	807	1561	145	218	33
LFP 160 - 2-A	27 / 30	35	33	31	28	24	807	1618	145	218	33
LFP 160 - 2	26 / 35	42	40	38	35	32	807	1681	145	218	33
LFP 160 - 3AA	30 / 40	49	46	42	38	33	963	1907	145	218	39
LFP 160 - 3-A	30 / 40	57	54	50	46	41	963	1907	145	218	39
LFP 160 - 3	37 / 50	63	60	57	53	48	963	1907	145	218	39
LFP 160 - 4AA	45 / 60	73	69	64	58	52	1119	2349	188	218	45
LFP 160 - 4 A	45 / 60	80	76	71	65	59	1119	2349	188	218	45
LFP 160 - 4	55 / 75	87	83	79	74	67	1119	2459	188	218	45
LFP 160 - 5AA	55 / 75	95	90	84	76	68	1275	2615	188	218	51
LFP 160 - 5-A	55 / 75	101	96	90	83	75	1275	2615	188	218	51
LFP 160 - 5	63 / 85	109	96	98	91	83	1275	2615	188	218	51
LFP 160 - 6AA	63 / 85	116	110	103	94	84	1431	2771	188	218	57
LFP 160 - 6-A	75 / 100	123	118	111	102	92	1431	2991	188	218	57
LFP 160 - 6	75 / 100	130	124	117	109	99	1431	2991	188	218	57
LFP 160 - 7AA	75 / 100	137	130	122	112	100	1587	3147	188	218	64
LFP 160 - 7-A	93 / 125	144	137	128	118	107	1587	3327	188	218	64
LFP 160 - 7	93 / 125	150	143	135	125	113	1587	3327	188	218	64
LFP 160 - 8AA	93 / 125	157	149	139	127	114	1743	3483	188	218	70
LFP 160 - 8 A	93 / 125	163	155	145	134	121	1743	3483	188	218	70
LFP 160 - 8	93 / 125	169	161	152	140	127	1743	3483	188	218	70
LFP 160 - 9AA	110 / 150	179	170	159	146	131	1899	3589	237	227	80
LFP 160 - 9-A	110 / 150	186	177	166	153	138	1899	3589	237	227	80
LFP 160 - 9	110 / 150	192	183	172	160	145	1899	3589	237	227	80
LFP 160 - 10AA	110 / 150	-	-	-	-	-	2351	404	237	227	86
LFP 160 - 10-A	132 / 175	-	-	-	-	-	2403	4273	237	227	86
LFP 160 - 10	132 / 175	-	-	-	-	-	2403	4273	237	227	86
LFP 160 - 11	132 / 175	-	-	-	-	-	2559	4429	237	227	93
LFP 160 - 12	150 / 200	-	-	-	-	-	2714	4784	286	227	99
LFP 160 - 13	185 / 250	-	-	-	-	-	2870	5090	286	227	105
LFP 160 - 14	185 / 250	-	-	-	-	-	3025	5245	286	227	111
LFP 160 - 15	190 / 250	-	-	-	-	-	3259	5639	286	227	118

* Motor type / size may change as per requirement.

** Maximum diameter of pump with two cable guard.



Table of Head Losses in Ordinary Pipes

www.liforcepumps.com



Upper figures indicate the velocity of water in m/sec.

Lower figures indicate head in metres per 100 metres of straight pipes

Quantity of Water			PELM/PEH PN 10											
m ³ /h	Litres/min.	Litres/sec.	PELM				PEH							
			25	32	40	50	63	75	90	110	125	140	160	180
			20.4	26.2	32.6	40.8	51.4	73.6	73.6	90.0	102.2	114.06	130.8	147.2
0.6	10	0.16	0.49	0.30	0.19	0.12								
0.9	15	0.25	0.76	0.46	0.3	0.19	0.12							
1.2	20	0.33	1.0	0.61	0.39	0.25	0.16							
1.5	25	0.42	1.3	0.78	0.5	0.32	0.2	0.14						
1.8	30	0.50	1.53	0.93	0.6	0.38	0.24	0.17						
2.1	35	0.58	1.77	1.08	0.69	0.44	0.28	0.2						
2.4	40	0.67	2.05	1.24	0.80	0.51	0.32	0.23	0.16					
3.0	50	0.83	2.54	1.54	0.99	0.43	0.4	0.28	0.2					
3.6	60	1.00	3.06	1.85	1.2	0.76	0.48	0.34	0.24	0.16				
4.2	70	1.2	3.43	2.08	1.34	0.86	0.54	0.38	0.26	0.18				
4.8	80	1.33	3.8	2.27	1.49	1.02	0.64	0.46	0.31	0.2				
5.4	90	1.50	4.2	2.48	1.65	1.15	0.72	0.51	0.35	0.24	0.18			
6.0	100	1.67	4.6	2.7	1.8	1.28	0.8	0.56	0.39	0.26	0.2			
7.5	125	2.08	5.4	3.1	2.0	1.4	0.9	0.63	0.43	0.28	0.2	0.20		
9.0	150	2.50	6.0	3.5	2.2	1.55	1.0	0.70	0.49	0.33	0.25	0.20		
10.0	170	2.78	6.6	3.8	2.4	1.7	1.1	0.77	0.53	0.36	0.26	0.20		
12	200	3.33	7.5	4.3	2.7	1.9	1.2	0.84	0.59	0.39	0.30	0.24		
15	250	4.17	8.5	4.9	3.1	2.1	1.4	0.94	0.69	0.46	0.36	0.28		
18	300	5.00	9.5	5.5	3.5	2.3	1.5	1.0	0.75	0.50	0.38	0.29		
24	400	6.67	11.0	6.3	4.0	2.6	1.7	1.1	0.8	0.55	0.41	0.31	0.25	
30	500	8.33	12.5	7.1	4.5	2.9	1.9	1.2	0.88	0.6	0.43	0.32	0.25	
36	600	10.0	14.0	8.0	5.0	3.2	2.1	1.3	0.96	0.65	0.45	0.33	0.25	
42	700	11.7	15.5	8.9	5.5	3.5	2.3	1.4	1.0	0.7	0.47	0.34	0.25	
48	800	13.3	17.0	9.8	6.0	3.8	2.5	1.5	1.05	0.75	0.48	0.35	0.25	
54	900	15.0	18.5	10.7	6.5	4.1	2.7	1.6	1.1	0.8	0.49	0.36	0.25	
60	1000	16.7	20.0	11.6	7.0	4.4	2.9	1.7	1.15	0.85	0.5	0.37	0.25	
75	1250	20.8	23.5	14.0	8.5	5.2	3.4	2.0	1.3	0.95	0.55	0.4	0.25	
90	1500	25.0	27.0	16.5	10.0	6.0	3.9	2.3	1.5	1.1	0.6	0.42	0.25	
105	1750	29.2	30.5	19.0	11.5	6.8	4.4	2.6	1.7	1.2	0.65	0.44	0.25	
120	2000	33.3	34.0	21.5	13.0	7.6	5.0	2.9	1.9	1.3	0.7	0.46	0.25	
150	2500	41.7	38.5	25.0	15.0	8.8	5.8	3.3	2.2	1.5	0.8	0.5	0.25	
180	3000	50.0	43.0	29.0	17.0	10.0	6.6	3.7	2.5	1.7	0.9	0.55	0.25	
240	4000	66.7	49.5	35.5	20.0	12.5	8.0	4.5	3.1	2.1	1.1	0.65	0.25	
300	5000	83.3	56.0	42.0	23.0	15.0	9.5	5.2	3.6	2.4	1.3	0.75	0.25	

The table is based on a nomogram.
 Roughness: K=0.1mm
 Water temperature: t=10°C

Subject to alterations



Table of Head Losses in Ordinary Pipes

www.lifeorcepumps.com



Upper figures indicate the velocity of water in m/sec.

Lower figures indicate head in metres per 100 metres of straight pipes

Quantity of Water			Head Losses in Ordinary Water Pipes												
m ³ /h	Litres/min.	Litres/sec.	Nominal Pipe Diameter in Inches and Internal Diameter in (mm)												
			½"	¾"	1"	1¼"	1½"	2"	2½"	3"	3 ½"	4"	5"	6"	
			15.75	21.25	27.00	35.75	41.25	52.50	68.00	80.25	92.50	105.0	130.0	155.5	
0.6	10	0.16	0.855 9.910	0.470 5.407	0.292 3.484										
0.9	15	0.25	1.282 15.11	0.705 8.269	0.438 5.270	0.249 2.916									
1.2	20	0.33	1.710 20.53	0.940 11.28	0.584 6.997	0.331 3.970	0.249 2.916								
1.5	25	0.42	2.138 25.65	1.174 14.07	0.730 8.760	0.415 4.977	0.312 3.744								
1.8	30	0.50	2.566 30.78	1.409 16.90	0.874 10.477	0.498 5.977	0.374 4.480	0.231 2.772							
2.1	35	0.58	2.993 35.91	1.644 19.73	1.022 12.26	0.581 6.977	0.434 5.211	0.269 3.231							
2.4	40	0.67		1.879 22.56	1.168 14.04	0.664 7.977	0.499 5.977	0.308 3.691							
3.0	50	0.83		2.349 28.18	1.460 17.52	0.830 9.977	0.623 7.477	0.385 4.621	0.229 2.751						
3.6	60	1.00		2.819 33.80	1.761 21.12	0.998 11.977	0.748 8.977	0.462 5.471	0.278 3.331						
4.2	70	1.12		3.288 39.42	2.043 24.51	1.162 13.977	0.873 10.477	0.539 6.471	0.321 3.831	0.231 2.831					
4.8	80	1.23			2.335 28.18	1.328 16.04	0.997 11.977	0.616 7.477	0.367 4.371	0.263 3.171					
5.4	90	1.50			2.627 31.52	1.494 17.97	1.122 13.477	0.693 8.271	0.413 4.911	0.269 3.211					
6.0	100	1.67			2.919 34.86	1.660 19.97	1.247 14.977	0.770 9.271	0.459 5.451	0.329 3.891	0.238 2.891				
7.5	125	2.08			3.649 43.78	2.075 24.91	1.558 18.477	0.962 11.477	0.574 6.771	0.412 4.911	0.310 3.711	0.241 2.911			
9.0	150	2.50				2.490 29.82	1.870 22.477	1.154 13.977	0.668 7.977	0.494 5.871	0.372 4.451	0.289 3.411			
10.5	175	2.89			2.904 34.86	2.182 26.12	1.347 16.477	1.347 16.477	0.803 9.477	0.576 6.871	0.434 5.211	0.337 4.011			
12	200	3.33			3.319 39.81	2.493 29.82	1.539 18.477	0.910 10.977	0.659 7.977	0.496 5.911	0.481 5.711	0.385 4.611	0.251 3.011		
15	250	4.17			4.149 49.78	3.117 37.32	1.924 23.077	1.147 13.477	1.147 13.477	0.823 9.977	0.620 7.477	0.481 5.711	0.314 3.711	0.251 3.011	
18	300	5.00				3.740 44.82	2.309 27.52	1.377 16.477	1.377 16.477	0.988 11.477	0.744 8.977	0.577 6.871	0.377 4.511	0.263 3.211	
24	400	6.67			4.987 59.81	3.078 36.32	1.834 22.077	1.834 22.077	1.834 22.077	1.317 15.477	0.992 11.977	0.770 9.271	0.502 6.011	0.351 4.211	
30	500	8.33				3.848 45.81	2.295 27.52	1.647 19.477	1.647 19.477	1.240 14.477	0.962 11.477	0.762 9.271	0.482 5.711	0.337 4.011	
36	600	10.0				46.18 55.81		2.753 33.077	1.976 23.52	1.488 17.477	1.165 13.977	0.753 9.271	0.482 5.711	0.320 3.811	
42	700	11.7						3.212 38.52	2.306 27.52	1.736 20.977	1.347 15.977	0.879 10.477	0.614 7.477	0.417 5.011	
48	800	13.3						3.671 44.02	2.635 31.52	1.984 23.52	1.540 18.477	1.009 11.977	0.620 7.477	0.417 5.011	
54	900	15.0						4.130 49.52	2.964 35.52	2.232 27.52	1.732 20.977	1.130 13.977	0.790 9.271	0.417 5.011	
60	1000	16.7						4.589 55.02	3.294 39.52	2.480 29.52	1.925 23.077	1.296 15.977	0.877 10.477	0.417 5.011	
75	1250	20.8							4.117 49.52	3.100 37.52	2.406 28.52	1.570 18.977	1.097 12.977	0.417 5.011	
90	1500	25.0							4.941 59.02	3.720 44.52	2.887 34.52	1.883 22.977	1.316 15.977	0.417 5.011	
105	1750	29.2							3.368 40.52	3.340 40.52	2.480 29.52	1.835 22.077	1.535 18.077	0.417 5.011	
120	2000	33.3							4.960 59.52	3.850 46.52	2.977 35.52	2.197 26.52	1.754 21.077	0.417 5.011	
150	2500	41.7								4.812 57.52	2.511 30.52	2.511 30.52	2.193 26.52	0.417 5.011	
180	3000	50.0									3.139 37.52	3.139 37.52	2.632 31.52	0.417 5.011	
240	4000	66.7										3.787 45.52	3.787 45.52	0.417 5.011	
300	5000	83.3											5.523 65.52	0.417 5.011	
90°C bends, slide valves			1.0	1.0	1.1	1.2	1.4	1.6	1.8	2.0	2.2	2.4	2.7	2.5	
T-piece, non-return valves			4.0	4.0	4.0	5.0	5.0	6.0	6.0	6.0	6.0	6.0	7.0	9.0	

The table is calculated in accordance with H. Lange's new formula $k = 0.02$ and for a water temperature of 10°C

The head loss in bends, slide valves, T-pieces and non-return valves is equivalent to the metres of straight pipe stated in the last two lines of the table. To find the head loss in foot valves multiply the loss in T-pieces by two.



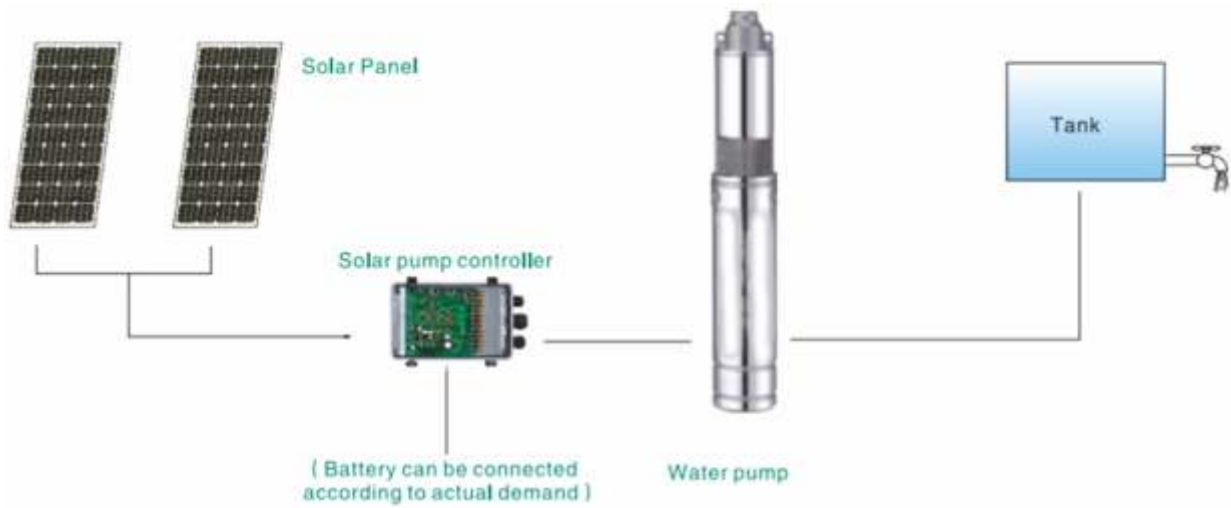



LIFE FORCE
Pumps | Motors



PUMPS | PIPES | CABLES | SOLAR PUMPS



ISO 9001:2015 & CE Certified Company



LIFE FORCE PUMPS LLP

Manufacturer of Stainless Steel Submersible Pumps

Email : info@lifeforcepumps.com
Website : www.lifeforcepumps.com
Phone : +91 89828 88747

Plot no 61 Dhannad Road Near Khedapati,
By Pass Road, Sector-1 Pithampur
District. Dhar-454775 (M.P.) INDIA